

37th ESNR ANNUAL MEETING

21st Advanced Course in Diagnostic Neuroradiology
5th Advanced Course in Interventional Neuroradiology

FRANKFURT, GERMANY
September 28-October 1, 2013

President
Friedhelm E. Zanella

FINAL PROGRAM



Committees

ESNR - European Society of Neuroradiology Diagnostic and Interventional

Executive Committee

President

E. Turgut Tali, Turkey

Vice President

Majda M. Thurnher, Austria

Past President

Paul M. Parizel, Belgium

Secretary General

Guido Wilms, Belgium

Treasurer

Johan van Goethem, Belgium

Secretary of the Council of Institutional Members

Laurent Pierot, France

Chair of the Subspeciality Committee, Diagnostic Neuroradiology

Majda M. Thurnher, Austria

Chair of the Subspeciality Committee, Head and Neck Neuroradiology

Alex Rovira Cañellas, Spain

Chair of the Subspeciality Committee, Interventional Neuroradiology

Michael Söderman, Sweden

Chair of the Subspeciality Committee, Paediatric Neuroradiology

Andrea Rossi, Italy

Chair of the Subspeciality Committee, Spine Neuroradiology, Diagnostic and Interventional

Mario Muto, Italy

ESNR 2013

Congress President

Friedhelm E. Zanella, Germany

Secretary General

Joachim Berkefeld, Germany

Local Scientific Committee

Joachim Berkefeld, Germany

Meike Stahmer, Germany

Elke Hattingen, Germany

Local Organizing Committee

Friedhelm E. Zanella, Germany

Joachim Berkefeld, Germany

Elke Hattingen, Germany

Marlies Wagner, Germany

Meike Stahmer, Germany

Welcome Message

It is my great honour and privilege to welcome you in Frankfurt, to the 37th Annual Meeting of the European Society of Neuroradiology.

The 37th Meeting will include two parallel courses, the 21st Advanced Course in Diagnostic Neuroradiology and the 5th Advanced Course in Interventional Neuroradiology to be held on September 28, while the Annual Meeting will be held from September 29 to October 1. The highest purpose of the ESNR annual event is calling European and non-European experts to meet and debate the state of the art of our branch of medicine confirming the high level of science and education in neuroradiology.

Both the advanced courses and the Meeting offer a great opportunity for neuroradiologists and other professionals to interact and exchange ideas with their colleagues from Europe and beyond.

As President of the Congress, it is a pleasure to underline the strenght of our society. Thanks to the presence of many world renowned speakers there will be updates in key clinical areas of diagnostic and interventional neuroradiology.

Shorter communications will offer opportunity for younger neuroradiologists to present their scientific work. The daily poster sessions will be also an important part of this congress. Besides the refresher courses embedded within the scientific program there will be the workshops which are focused on special topics of the diagnostic and interventional neuroradiology. A hot topic session will present the important future of this exciting speciality. Last but not least time to meet the experts, either during the scientific sessions or at the social events is also fundamental in our Meeting to know people and share the relevant experiences.

Frankfurt is a modern and technologically advanced metropolis that can be easily reached by plane, train or car. This exciting city, located in the center of Germany, offers a lot of interesting things to do and places to be visited, beside our scientific commitments. You will see the world known skyline of Frankfurt which mainly is a result of a lot of towers of different German and European banks. There are many fascinating museums and galleries and, if you like music, there are different kinds of performances from the well-known opera to live music in different pubs, which represent an important part of the exciting night-life of this international city.

The somehow unusual timing of the Congress, from Saturday to Tuesday (instead of Thursday-Sunday) is caused by the famous fairs that will take place in the city, the IAA (International Automobile Fair) held just before the congress and the International Book Fair that will be held straight after.

Again I am delighted to welcome you in Frankfurt and I hope that this event will remain in your memory for a long time.

*Prof. Friedhelm E. Zanella
President of the 37th ESNR Annual Meeting*



37th ESNR ANNUAL MEETING

Index

PROGRAM AT A GLANCE	p. 5
SCIENTIFIC INFORMATION	p. 9
GENERAL INFORMATION	p. 11
SOCIAL EVENTS	p. 12
SCIENTIFIC PROGRAM	p. 13
Saturday, September 28, 2013	
21 st Advanced Course in Diagnostic Neuroradiology "Beyond morphology: advanced imaging modalities"	
5 th Advanced Course in Interventional Neuroradiology "Chronic ischemia of the brain and revascularization"	
Sunday, September 29, 2013	p. 16
37 th ESNR Annual Meeting	
Monday, September 30, 2013	p. 25
37 th ESNR Annual Meeting	
Tuesday, October 1, 2013	p. 39
37 th ESNR Annual Meeting	
POSTER SESSION	p. 42
Brain tumors, diagnostic and interventional	p. 42
Head and neck	p. 43
Inflammatory, demyelinating and degenerative diseases of the brain	p. 44
Pediatric neuroradiology	p. 46
Spine, diagnostic imaging	p. 46
Spine, intervention	p. 47
Stroke and cerebrovascular disease, diagnostic	p. 48
Stroke and cerebrovascular disease, interventional: aneurysms and vascular malformations	p. 49
Stroke and cerebrovascular disease, interventional: vessel obstructions and recanalisation	p. 50
Other/free topics	p. 51
Advanced/new imaging modalities	p. 53
INDUSTRY LUNCH SYMPOSIA	p. 55
AKNOWLEDGEMENTS	p. 56
EXHIBITION	p. 57
CONTACTS	p. 60

37th ESNR ANNUAL MEETING

Program at a glance

SATURDAY, SEPTEMBER 28						
ADVANCED COURSE DIAGNOSTIC / ADVANCED COURSE INTERVENTIONAL						
	Room HZ 2	Room HZ 3	Room HZ 4	Room HZ 5	Room HZ 15	
8:45-10:15	Diagnostic - Beyond morphology: advanced imaging modalities Trauma		8:45-10:00	Interventional - Chronic ischemia of the brain and revascularization Anatomical and pathophysiological basics		
10:15-10:45		Coffee Break	10:00-10:30		Coffee Break	
10:45-12:15	Diagnostic Brain tumors: new biological MR-techniques		10:30-12:15	Interventional Clinical findings and imaging of chronic ischemia		
12:15-14:00			Lunch			
14:00-15:20	Diagnostic Neuroinflammation		14:00-15:20	Interventional Treatment strategies in the light of recent randomized trials		
15:20-15:50			Coffee Break			
15:50-16:30	Diagnostic Pain and epilepsy: can we image it?		15:50-17:30	Interventional Update on carotid and intracranial stenting after the RCTs		
16:30-17:45	Diagnostic Neurodegeneration: MR-modalities against biomarkers					
17:30			Welcome reception			

37th ESNR ANNUAL MEETING

Program at a glance

SUNDAY, SEPTEMBER 29					
Room HZ 2	Room HZ 3	Room HZ 4	Room HZ 5	Room HZ 15	
08:00-09:00	08:00-09:00 Refresher Course Diagnostic Pediatric imaging	Refresher Course Interventional Intracranial aneurysms			
09:00-10:00	Plenary session: Brain tumors				
Coffee Break					
10:00-10:30					
10:30-11:30	10:30-11:30 Diagnostic special focus - Spinal imaging	10:30-11:30 Interventional special focus - Interventional stroke treatment			
11:30-12:00	Opening ceremony				
12:00-12:30	Honorary Membership Ceremony				
12:30-14:00	Lunch		12:30-14:00 Lunch	12:30-14:00 Poster Presentation Session	
14:00-15:30	ESNR Awards and European Diplomas Ceremony	13:00-13:30 PENUMBRA Symposium	13:00-14:00 BRACCO Symposium		
		14:00-15:40 Parallel scientific session Stroke diagnostic	14:00-15:30 Parallel scientific session with introductory invited presentation Interventional stroke and revascularization	13:30-15:30 Parallel scientific session with introductory invited presentation Interventional aneurysms: new implants	13:30-15:30 Workshop Stroke treatment
Coffee Break					
15:30-16:00					
16:00-18:00	16:00-18:00 Parallel scientific session with introductory invited presentation Diagnostic advanced MRI-techniques	16:00-18:00 Parallel scientific session with introductory invited presentation White matter diseases	16:00-18:00 Parallel scientific session with introductory invited presentation Spinal imaging	16:00-18:00 Parallel scientific session with introductory invited presentation Interventional AVM and AVF	

37th ESNR ANNUAL MEETING

Program at a glance

MONDAY, SEPTEMBER 30									
Room HZ 2		Room HZ 3		Room HZ 4		Room HZ 5		Room HZ 15	
08:00-09:00	Refresher Course Diagnostic Dementias beyond Alzheimer and psychiatric disorders	08:00-09:00	Refresher Course Interventional SAH and vasospasm			09:00-11:00	Workshop MRI spectroscopy: what does that have to do with alcohol?		Workshop Stroke treatment
09:00-10:00	Future MRI	09:00-10:00	Parallel scientific session Stroke Aneurysm/AVM			09:00-11:30			
10:00-10:30		Coffee Break							
10:30-11:30	Diagnostic special focus Inflammatory disease	10:30-11:30	Interventional special focus - Clinical outcome after interventional procedures						
11:30-13:00	Neuroradiology: from the past to the future. Dedicated to Hans Hacker	11:30-13:00	Parallel scientific session Brain tumors 1	11:30-13:00	Parallel scientific session Pediatrics				
13:00-14:00	Lunch	13:00-14:00	MICROVENTION Symposium	13:00-13:30	SIEMENS Symposium	13:00-14:00	Lunch	13:00-14:00	Poster Presentation Session
14:00-15:00	ESNR General Assembly								
15:00-18:00	ESNR Interventional HOT TOPICS	15:00-16:30	Parallel scientific session Brain Tumors 2	15:00-16:30	Joint session on pediatric neuroradiology with the ASPNR Monothematic minicourse "Advances in the understanding of brain malformations"	15:00-16:30	Parallel scientific sessions with introductory invited presentation Spine	15:00-16:30	Parallel scientific sessions with introductory invited presentation Head and neck
		16:30-17:00		Coffee Break					
		17:00-18:30	Parallel scientific session Stroke recanalization	17:00-18:30	Parallel scientific session Inflammatory disease	17:00-18:30	Parallel scientific session Free topics	17:00-18:30	Parallel scientific session Advanced imaging: epilepsy and consciousness

37th ESNR ANNUAL MEETING

Program at a glance

TUESDAY, OCTOBER 1					
	Room HZ 2	Room HZ 3	Room HZ 4	Room HZ 5	Room HZ 15
08:00-09:00	Refresher Course Diagnostic Epilepsy, head and neck	08:00-09:00 Refresher Course Interventional Advanced angiographic imaging and radiation protection			
09:00-10:00	Paediatric	09:00-10:00 Imaging in psychiatry			
10:00-10:30	Coffee Break				
10:30-12:00	ESNR - ASNR Joint session	10:30-12:00 Parallel scientific session Advanced imaging "Future Techniques in neuroradiology "			
12:00-13:00	Closing ceremony				

SCIENTIFIC INFORMATION

21st ADVANCED COURSE IN DIAGNOSTIC NEURORADIOLOGY

Beyond morphology: advanced imaging modalities

5th ADVANCED COURSE IN INTERVENTIONAL NEURORADIOLOGY

Chronic ischemia of the brain and revascularization

The Courses take place on September 28 in Room HZ 2 and HZ 4 at the Hörsaalzentrum.

37th ESNR Annual Meeting

The ESNR Meeting takes place from September 29 to October 1 in Room HZ 2, HZ 3, HZ 4, HZ 5 and HZ 15 at Hörsaalzentrum.

Oral Presentations and Poster Session

There are 19 sessions in which the selected abstracts have been slotted. Abstracts received for poster presentation will be displayed in the Poster Session. All the abstracts are published on the dedicated issue of *Neuroradiology*, the official Journal of the European Society of Neuroradiology. The best poster will be selected by a Jury and will be awarded at the end of the Meeting.

POSTER PRESENTATION SESSIONS					
Sunday, September 29			Monday, September 30		
Slot time	Poster number	Chair	Slot time	Poster number	Chair
12:30 - 13:05	P.1.114 - P.1.120	A. Dörfler (Germany)	13:00 - 13:40	P.1.010 - P.1.017	M. Essig (Germany)
12:30 - 13:15	P.1.001 - P.1.009	E. Hattingen (Germany)	13:00 - 13:45	P.1.043 - P.1.051	L. Porto (Germany)
12:30 - 13:40	P.1.018 - P.1.031	M. Mack (Germany)	13:00 - 13:50	P.1.033 - P.1.042	A. Rovira (Spain)
12:45 - 13:45	P.1.052 - P.1.066	H. Lanfermann (Germany)	13:00 - 13:50	P.1.121 - P.1.130	M. Wagner (Germany)
12:45 - 13:55	P.1.067 - P.1.080	W. Kurre (Germany)	13:15 - 14:00	P.1.104 - P.1.113	B. Kress (Germany)
12:50 - 13:55	P.1.081 - P.1.093	B. Yan (Australia)			
13:00 - 13:50	P.1.094 - P.1.103	B. Schuknecht (Switzerland)			

(NEW!) Hot topics and Workshops

To increase the role of the ESNR-meeting as a forum for discussion of recent trends in Interventional Neuroradiology this year, two new formats are offered to participants:

Interventional Hot-Topics

Deals with actual controversies in the field of AVM, stroke and aneurysm treatment.

ARUBA, IMS III, ISAT and current status of the clipping/coiling debate as well as hypes with new devices are discussed after controversial statements by well known experts.

- **Monday, September 30, hrs 15:00 - 18:00**

SCIENTIFIC INFORMATION

Hands-on-Workshop Interventional Stroke Treatment

Six companies have been invited to prepare vascular models or simulators to demonstrate the basic techniques and handling of stent-retrievers and aspiration catheters for participants who think about having an interventional stroke service in the future.

Experienced neuroradiologists are available as instructors for technical and clinical discussions.

- **Sunday, September 29, hrs 13:30 - 15:30 room HZ 15**
- **Monday, September 30, hrs 09:00 - 11:00 room HZ 15**

Please note that the number of participants is limited to 24 persons per session. Please check for availability at the registration desk.

Technical Equipments for Speakers and Authors of Oral presentations

Both PC and Mac data projection are available at the Meeting. Each Room is provided with a laptop. Use of one's personal laptop is not allowed. Speakers with their personal laptop are kindly requested to go to the Speaker Slide Center at least 2 hours before the presentation to have their presentation copied.

For any special requirement, please contact the Secretariat.

Speakers are invited to be in the assigned Room for presentation at least 10 minutes before the beginning of the Session and respect the timing assigned to their presentation.

Official Language

English is the official language of the Meeting. Simultaneous translation will not be provided.

Certificate of Attendance

The electronic copy of the certificate of attendance will be sent to all the attendees after the Meeting.

UEMS - European Union of Medical Specialists

The Meeting has received 15 UEMS credits; the two Advanced Courses have received 6 UEMS credits each. Credits are valid all over Europe, the United States and Canada (for reciprocity agreement with the American Medical Association). The certificate will be sent by email after the Meeting to all the attendees, who have filled in the feedback form.

In order to guarantee the regularity and transparency of the accreditation procedure, all the Conflict of Interest Disclosure Forms signed by speakers are available for consultation at the Secretariat Desk.

GENERAL INFORMATION

Venue

Campus Westend
Goethe Universität Frankfurt am Main
Grüneburgplatz 1
60323 Frankfurt - Germany

Registration Desk opening hours

- September 27 - hrs 16.00 - 19.00
- September 28 - hrs 7.30 - 18.00
- September 29 - hrs 7.30 - 18.00
- September 30 - hrs 7.30 - 18.30
- October 01 - hrs 7.30 - 13.00

Admission to the Meeting

Name badges are used as passes. All participants are requested to wear their name badge during the Meeting and social events.

Badges are distinguished as follows:

ESNR Meeting Delegate	No Color
Advanced Courses Delegates	Blue
Invited Speakers and Chairs	Red
Exhibitors	Yellow

On-site Registrations (VAT included)

	September 28, 2013 Advanced Courses (1 day)	September 28-October 1, 2013 Advanced Courses + ESNR Meeting (4 days)	September 29 October 01, 2013 ESNR Meeting (3 days)
Member	€ 370,00	€ 775,00	€ 675,00
Non Member	€ 550,00	€ 995,00	€ 895,00
Junior Member	€ 350,00	€ 520,00	€ 450,00
Institutional Member	€ 540,00	€ 985,00	€ 885,00
Daily Registration Member	€ 250,00		
Daily Registration Non-Member	€ 350,00		
Gala Dinner	€ 60,00	€ 60,00	€ 60,00
ESNR membership	€ 140,00		

Registration fee includes: admission to the selected Courses and/or Meeting, congress kit, daily coffee break, lunch, welcome reception and UEMS credits.

How to get registered

Onsite Payment is possible by:

- Cash (Euro)
- Credit Card: all major credit cards are accepted (American Express, VISA, Eurocard/Master Card)

Lunch

Lunches will be served in the exhibition area and at the entrance of the rooms

Exhibition

Exhibition area will be open throughout the Meeting

Insurance

Meeting organizers cannot accept liability for personal injuries or for damage or loss of property belonging to Meeting participants, either during or as a result of the Meeting. Please check the validity of your own insurance.

SOCIAL EVENTS

Saturday, September 28 - hrs 17.30 - 19.00

Welcome Reception

The Welcome Reception will take place at Campus Westend. This is an informal evening open to all delegates attending the Advanced Course and/or ESNR Meeting.

Sunday, September 29 - hrs 19.30

ESNR Gala Dinner

Palmengarten Gesellschaftshaus
Palmengartenstraße 11
60325 Frankfurt am Main

The Gala Dinner will be held at the Palmengarten Gesellschaftshaus in Frankfurt. This beautiful building is one of the most important and historical buildings in Frankfurt. You will have the chance to admire the Festsaal together with its gallery presented in new splendour. Sumptuous ornamental details in the Neo-Renaissance style and the well-preserved walls give the Festsaal its distinctive character. Its special atmosphere is also owed to two classical chandeliers and the beauty of the historical parquet floor. Palmengarten is located in the popular botanic garden, „Garden of Palms“, located near by the Goethe University Campus

After dinner a well-known band will offer the chance of dancing until midnight.

This evening is open to all delegates at a fee of € 60,00.

SCIENTIFIC PROGRAM

Saturday, September 28, 2013

21st Advanced Course in Diagnostic Neuroradiology
"Beyond morphology: advanced imaging modalities"

3rd Advanced Course in Interventional Neuroradiology
"Chronic ischemia of the brain and revascularization"

ROOM HZ 2

08:45 - 10:15

DIAGNOSTIC • Beyond morphology: advanced imaging modalities

Trauma

Chair: F.E. Zanella (Germany)

Traumatic brain injury

P.M. Parizel (Belgium)

Trauma from the perspective of the neurosurgeon

C. Renner (Germany)

MRI of spinal injury

J. van Goethem (Belgium)

Room HZ 4

08:45 - 10:00

INTERVENTIONAL • Chronic ischemia of the brain and revascularization

Anatomical and pathophysiological basics

Chair: M. Knauth (Germany)

Delayed and chronic ischemia of the brain - an underestimated feature?

M. Söderman (Sweden)

Vascular borderzones, microcirculation and collateral supply

A. Valavanis (Switzerland)

Basics of cerebral hemodynamics and metabolism in acute and chronic ischemia

J. Sobesky (Germany)

10:00 - 10:45

Coffee Break

Room HZ 2

10:45 - 12:15

DIAGNOSTIC • Beyond morphology: advanced imaging modalities

Brain tumors: new biological MR-techniques

Chair: H. Lanfermann (Germany)

Requests from neurooncologist

J. Steinbach (Germany)

Susceptibility weighted techniques

R. Gasparotti (Italy)

MR derived biomarkers for quantification of microvascular disease in the ageing brain and neurodegenerative disorders

A. Jackson (United Kingdom)

Diffusion techniques

P. M. Parizel (Belgium)

SCIENTIFIC PROGRAM

Saturday, September 28, 2013

Room HZ 4

10:30 - 12:15

INTERVENTIONAL • Chronic ischemia of the brain and revascularization

Clinical findings and imaging of chronic ischemia

Chair: B. Yan (Australia)

Clinical and neuropsychological findings in patients with hemodynamic ischemia

H. Steinmetz (Germany)

Imaging patterns of ischemic lesions and differential diagnosis

B. Schuknecht (Switzerland)

Advanced imaging-techniques in chronic hypoperfusion of the brain

M. Wagner (Germany)

Challenges of brain perfusion measurement

M. Wintermark (USA)

Discussion

12:15 - 14:00

Lunch

Room HZ 2

14:00 - 15:20

**DIAGNOSTIC • Beyond morphology: advanced imaging modalities
Neuroinflammation**

Chair: L. Penev (Bulgaria)

MR imaging in non-MS inflammation: immune-mediated diseases

T. Yousry (United Kingdom)

MR imaging in non-MS neuroinflammation: granulomatous diseases

F. Bonneville (France)

MR imaging: neuroinflammation in immunocompromised patients

A. Rovira (Spain)

Discussion

Room HZ 4

14:00 - 15:20

INTERVENTIONAL • Chronic ischemia of the brain and revascularization

Treatment strategies in the light of recent randomized trials

Chair: G. Schroth (Switzerland)

Revascularization in hemodynamic ischemia: which evidence do we have?

L.J. Kappelle (The Netherlands)

Medical therapy of patients with hemodynamic impairment.

Can the brain survive without vessels?

B. Yan (Australia)

Neurointerventional revascularization techniques

J. Gralla (Switzerland)

EC-IC-Bypass in ischemic patients?

M. Czabanka (Germany)

15:20 - 15:50

Coffee Break

SCIENTIFIC PROGRAM

Saturday, September 28, 2013

Room HZ 2

15:50 - 16:30

**DIAGNOSTIC • Beyond morphology: advanced imaging modalities
Pain and epilepsy: can we imagine it?**

Chair: G. Krumina (Latvia)

Imaging pain

H. Boecker (Germany)

MRI in focal, non-lesional epilepsy

S. Knake (Germany)

Room HZ 2

16:30 - 17:45

**DIAGNOSTIC • Beyond morphology: advanced imaging modalities
Neurodegeneration: MR-modalities against biomarkers**

Chair: R. Vanninen (Finland)

Neurodegeneration: inflammatory reaction or vascular disorder

M. Heneka (Germany)

Imaging in Parkinson and other extrapyramidal disorders

T. Stošić-Opinčal (Serbia)

Case presentation and discussion

S. Weidauer (Germany), M. Wagner (Germany)

Room HZ 4

15:50 - 17:30

**INTERVENTIONAL • Chronic ischemia of the brain and
revascularization**

Update on carotid and intracranial stenting after the RCTs

Chair: J. Trenkler (Austria)

Carotid stenting in neuroradiology today: standard or niche indication?

O. Jansen (Germany)

Stenting of intracranial stenoses after SAMMPRIS

C. Cognard (France)

**Periinterventional stroke, hemorrhage and hyperperfusion: how to avoid
and manage complications during and after revascularisation**

I. Szikora (Hungary)

How dangerous is revascularization? Cases and complications session

D. Rüfenacht (Switzerland)

SCIENTIFIC PROGRAM

Sunday, September 29, 2013

37th ESNR Annual Meeting

Room HZ 2

08:00 - 09:00

REFRESHER COURSE DIAGNOSTIC: Pediatric imaging

Chair: P. Due-Tønnessen (Norway)

Differential diagnosis of pediatric brain tumors

L. Porto (Germany)

Real time MR Technique for fetuses and neonates

T. Feygin (USA)

Room HZ 3

08:00 - 09:00

REFRESHER COURSE INTERVENTIONAL: Intracranial aneurysms

Chair: J. Rusalleda Nadal (Spain), M. Söderman (Sweden)

Coiling vs. clipping in ruptured and unruptured aneurysms: long-term-efficacy and status of the debate

A. Molyneux (United Kingdom)

How to coil an aneurysm. Individual skill or reliable standards?

L. Pierot (France)

Room HZ 2

09:00 - 10:00

Brain tumors

Chair: P.M. Parizel (Belgium), M. Buruian (Romania)

Lymphomatoid spectrum disorders, update 2013

A. Osborn (USA)

Advanced tumor MRI

M. Essig (Germany)

10:00 - 10:30

Coffee Break

Room HZ 2

10:30 - 11:30

DIAGNOSTIC SPECIAL FOCUS • Spinal Imaging

Chair: F.E. Zanella (Germany)

Advanced techniques for spine and spinal cord imaging

T. Krings (Canada)

High field strength at the spine, really a step forward?

U. Attenberger (Germany)

Differential diagnosis of acute myelopathy

M.M. Thurnher (Austria)

Room HZ 3

10:30 - 11:30

INTERVENTIONAL SPECIAL FOCUS • Interventional stroke treatment

Chair: R. von Kummer (Germany)

Randomized trials ahead: predictors for successful interventional stroke treatment

R. Wiest (Switzerland)

CT or MRI? Imaging for proper patient selection

A. Dörfler (Germany)

Materials, technical standards and procedural safety

G. Schroth (Switzerland)

SCIENTIFIC PROGRAM

Sunday, September 29, 2013

Room HZ 2

11:30 - 12.00 **OPENING CEREMONY**

12:00 - 12.30 **HONORARY MEMBERSHIP CEREMONY**

12:30 - 14.00 *Lunch*

Room HZ 2

14:00 - 14.45 **ESNR AWARDS AND EUROPEAN DIPLOMAS CEREMONY**

14:45 - 15.30 **EDINR CEREMONY**

Room HZ 15

13:30 - 15.30 **Workshop "Stroke treatment"**
J. Berkefeld (Germany), G. Schroth (Switzerland)

Room HZ 3

14:00 - 15.40 **Parallel scientific session**

Stroke diagnostic

Chair: R. Wiest (Switzerland), M. Wagner (Germany)

NONINVASIVE EVALUATION OF CEREBRAL ARTERIOVENOUS MALFORMATIONS BY 4D-CT ANGIOGRAPHY USING 320-DETECTOR ROW CT

*H. Tajiri, L. Jin, T. Tsukiyama, T. Okabe, H. Kamide, S. Sekine, T. Shimizu, T. Ohiwa
Shonan Kamakura General Hospital, Kamakura, Japan*

TEMPORAL CHANGES OF DIFFUSION KURTOSIS IMAGING IN STROKE PATIENTS

*P. Raab¹, M. Heeren², F. Donnerstag¹, E. Bültmann¹, P. Dellani¹, M. Hennig²,
K. Weißenborn², H. Lanfermann¹*

*¹Neuroradiology, Hannover Medical School, Hannover, Germany, ²Neurology,
Hannover Medical School, Hannover, Germany*

REGIONAL LEPTOMENINGEAL SCORE (RLMS) ON COMPUTED TOMOGRAPHY ANGIOGRAPHY/PERFUSION (CTA-CTP) CAN PREDICTS CLINICAL OUTCOMES IN PATIENTS WITH ACUTE ISCHEMIC STROKE (AIS)

E. Puglielli¹, M. Varrassi¹, M. Fuschi¹, V. Di Egidio²

*¹Interventional and Vascular Radiology, G. Mazzini Hospital, Teramo, Italy, ²General and
Interventional Radiology, S. Spirito Hospital, Pescara, Italy*

FALSE ISCHEMIC PENUMBRAS IN CT BRAIN PERFUSION STUDIES IN PATIENTS WITH ACUTE ISCHEMIC STROKE (AIS)

E. Puglielli¹, M. Varrassi¹, M. Fuschi¹, V. Di Egidio²

*¹Interventional and Vascular Radiology, G. Mazzini Hospital, Teramo, Italy, ²General and
Interventional Radiology, S. Spirito Hospital, Pescara, Italy*

MOTOR FUNCTION RECOVERY PREDICTION IN PATIENT WITH ACUTE ISCHEMIC STROKE USING DIFFUSION TENSOR IMAGING

T. Popova, R. Konovalov, M. Maksimova, M. Krotenkova

FSBI «Research Center of Neurology» under the RAMS, Moscow, Russia

DISTINCTION BETWEEN EXTRAVASATED IODINATED CONTRAST AGENT AND PARENCHYMAL HAEMORRHAGE IN MR IMAGING - AN IN-VITRO AND ANIMAL STUDY

*O. Nikoubashman¹, F. Jablawi³, E. Yousefian¹, L. Tanrikulu³, A. Woitok², T. Stopinski²,
R. Tolba², J. Schulz⁴, H. Clusmann³, M. Wiesmann¹*

*¹Klinik für Diagnostische und Interventionelle Neuroradiologie, Uniklinik Aachen, Aachen,
Germany, ²Institut für Versuchstierkunde, Uniklinik Aachen, Aachen, Germany,*

*³Klinik für Neurochirurgie, Uniklinik Aachen, Aachen, Germany, ⁴Klinik für Neurologie,
Uniklinik Aachen, Aachen, Germany*

SCIENTIFIC PROGRAM

Sunday, September 29, 2013

HAEMORRHAGE/CONTRAST STAINING AREAS AFTER MECHANICAL INTRA-ARTERIAL THROMBECTOMY IN ACUTE ISCHEMIC STROKE: IMAGING FINDINGS AND CLINICAL SIGNIFICANCE

O. Nikoubashman^{1,2}, M. Gindullis², K. Frohnhofer¹, R. Pjontek¹, M. Brockmann¹, A. Reich², J. Schulz², M. Wiesmann¹

¹ University Hospital Aachen, Department of Diagnostic and Interventional Neuroradiology, Aachen, Germany, ² University Hospital Aachen, Department of Neurology, Aachen, Germany

INTRACRANIAL ANEURYSM AS AN ATHEROSCLEROTIC DISEASE

A. Grams¹, B. Glodny², E. Maenner², E. Schoenherr², R. Helbok³, J. Petersen²

¹ Department of Neuroradiology, Innsbruck Medical University, Innsbruck, Austria,

² Department of Radiology, Innsbruck Medical University, Innsbruck, Austria, ³ Department of Neurology, Innsbruck Medical University, Innsbruck, Austria

BOLD-BASED MRI REVEALS HYPOXIC AREAS IN PATIENTS WITH STROKE OR SEVERE ARTERIAL STENOSIS

A. Gersing¹, M. Ankenbrank¹, V. Toth¹, S. Wunderlich², C. Zimmer¹, C. Preibisch¹

¹ Department of Neuroradiology, Technical University Munich, Munich, Germany,

² Department of Neurology, Technical University Munich, Munich, Germany

Room HZ 4

14:00 - 15:40

Parallel scientific session with introductory invited presentation

Interventional stroke and revascularization

Chair: I. Szikora (Hungary)

New devices and techniques

O. Jansen (Germany)

INITIAL CLINICAL EXPERIENCE WITH THE ADAPT TECHNIQUE: A DIRECT ASPIRATION FIRST PASS TECHNIQUE FOR STROKE THROMBECTOMY

D. Frei¹, A.S. Turk², A. Spiotta³, J. Mocco⁴, B. Baxter⁵, D. Fiorella⁶, A. Siddiqui⁷, M. Mokin⁷, M. Dewan⁴, H. Woo⁶, R. Turner³, H. Hawk², A. Miranpuri², I. Chaudry²

¹ Swedish Medical Centre, Department of Radiology, Englewood, CO, USA, ² Medical University of South Carolina, Department of Radiology, Charleston, SC, USA, ³ Medical University of South Carolina, Department of Neurosciences, Charleston, SC, USA,

⁴ University of Vanderbilt, Department of Radiology and Radiological Sciences, Nashville, TN, USA, ⁵ Erlanger Health System, Department of Radiology, Chattanooga, TN, USA, ⁶ Stony Brook University, Department of Neurosurgery, Stony Brook, NY, USA, ⁷ University at Buffalo, Department of Neurosurgery, Buffalo, NY, USA

SOLVING THE ISSUE OF RESTENOSIS AFTER STENTING OF INTRACRANIAL STENOSES: EXPERIENCE WITH TWO THIN STRUT DRUG ELUTING STENTS (DES) - TAXUS ELEMENT™ (BOSTON SCIENTIFIC) AND RESOLUTE INTEGRITY™ (MEDTRONIC INC.)

W. Kurre¹, M. Aguilar-Pérez¹, S. Fischer¹, G. Arnold², E. Schmid³, H. Bänzner³, H. Henkes¹

¹ Klinikum Stuttgart, Department of Neuroradiology, Stuttgart, Germany, ² Klinikum Sindelfingen, Department of Neurology, Sindelfingen, Germany, ³ Klinikum Stuttgart, Department of Neurology, Stuttgart, Germany

MECHANICAL RECANALIZATION OF ACUTE M1 OCCLUSIONS WITH THE PRESET® STENTRETRIEVER IN 48 PATIENTS - TECHNICAL SUCCESS AND CLINICAL OUTCOME

S. Prothmann¹, F. Kober¹, S. Wunderlich², J. Kleine¹, K. Kreiser¹, T. Boeckh-Behrens¹, C. Zimmer¹, H. Poppert²

¹ Klinikum rechts der Isar, Department of Neuroradiology, Munich, Germany, ² Klinikum rechts der Isar, Department of Neurology, Munich, Germany

Sunday, September 29, 2013

MECHANICAL THROMBECTOMY WITH DOUBLE SOLITAIRE STENTS

M. Stauder, M. Heddier, H. Nordmeyer, C.P. Stracke, R. Chapot
Alfried-Krupp Hospital, Essen, Germany

HIGH CLOT BURDEN IN ACUTE EMBOLIC STROKE IN THE ANTERIOR CIRCULATION: COMPARISON OF NEUROTHROMBECTOMY AND SYSTEMIC THROMBOLYSIS

A. Rohr¹, J. Meyne², P. Zimmermann², C. Riedel¹, F. Papengut², R. Stingle³, O. Jansen¹, G. Deuschl², A. Binder²

¹ UKSH Institute of Neuroradiology, Kiel, Germany, ² UKSH Department of Neurology, Kiel, Germany, ³ DRK Clinic Köpenick Department of Neurology, Berlin, Germany

THERAPY: A PROSPECTIVE, RANDOMIZED, CONTROLLED TRIAL TO EVALUATE THE ROLE OF MECHANICAL THROMBECTOMY AS ADJUNCTIVE TREATMENT TO IV RTPA FOR ACUTE ISCHEMIC STROKE THERAPY

R. von Kummer¹, J. Gerber¹, J. Mocco², P. Khatri³, O. Zaidat⁴, R. Gupta⁵

¹ Universitätsklinikum Dresden, Abteilung Neuroradiologie, Dresden, Germany, ² Vanderbilt University, Department of Neurological Surgery, Nashville, TN, USA, ³ University of Cincinnati, Department of Neurology, Cincinnati, OH, USA, ⁴ Medical College of Wisconsin, Department of Neurology, Neurosurgery & Radiology, Milwaukee, WI, USA, ⁵ Grady Memorial Hospital, Department of Neurology, Neurosurgery and Radiology, Atlanta, GA, USA

New ways of high resolution imaging in interventional practice*

L. Spelle (France)

Room HZ 5

14:00 - 15:30

Parallel scientific session with introductory invited presentation

Interventional aneurysms: new implants

Chair: L. Pierot (France), C. Cognard (France)

New implants for aneurysm treatment

S. Cekirge (Turkey)

STENT-ASSISTED COIL EMBOLIZATION WITH A CLOSED CELL STENT DEVICE

C. Taschner¹, W. Reith², J. Gralla³, R. Du Mesnil De Rochemont⁴, O. Singer⁴, C. Hader¹, S. Meckel¹, P. Papanagiotou², C. Roth², H. Körner², E. Dabew², U. Yilmaz², S. Zubler³, G. Schroth³, M. Schumacher¹, J. Berkefeld⁴

¹ Dept. of Neuroradiology, University Hospital Freiburg, Freiburg, Germany, ² Dept. of Neuroradiology, University Hospital Homburg/Saar, Homburg, Germany, ³ Dept. of Neuroradiology, University Hospital Bern, Bern, Switzerland, ⁴ Dept. of Neuroradiology, University Hospital Frankfurt, Frankfurt, Germany

FLOW DIVERTER STENTS IN BIFURCATION ANEURYSMS

S. Saleme, J.A. Mejia Nunez, S. Ponomarjova, D. Ayoub, T. Dinh, C. Mounayer
CHU de Limoges, Department of Neuroradiology, Limoges, France

INTENSIFYING PLATELET INHIBITION IN POOR RESPONDERS TO CLOPIDOGREL ACCORDING TO THE MULTIPLATE® ANALYZER DURING INTRACRANIAL FLOW-DIVERTING STENT IMPLANTATION

I. Oran¹, C. Cinar¹, H. Bozkaya¹, M. Korkmaz²

¹ Ege University Medical School Department of Radiology, Izmir, Turkey, ² Dumlupinar University Medical School Department of Radiology, Kutahya, Turkey

*Refer to pag. 55

Sunday, September 29, 2013

REOSTENTING TECHNIQUE: COMBINED USE OF DOUBLE LUMEN REMODELLING BALLOONS WITH LOW PROFILE STENTS: LVIS JR, LEO BABY AND ACCLINO

K. Kadziolka, L. Estrade, L. Pierot

CHU Reims, Interventional Neuroradiology Department, Reims, France

PIPELINE FLOW DIVERTING STENTS REDUCE ANEURYSM INFLOW WITHOUT RELEVANTLY AFFECTING STATIC INTRA-ANEURYSMAL PRESSURE

M. Brockmann¹, H.U. Kerl², H. Boll², T. Fiebig², G. Figueiredo², A. Förster², I.S. Nölte², C. Groden²

¹ *University Hospital of the RWTH Aachen, Department of Diagnostic and Interventional Neuroradiology, Aachen, Germany,* ² *University Medical Center Mannheim, Department of Neuroradiology, Mannheim, Germany*

COST EFFICIENCY AND FOLLOW-UP DATA USING THE PENUMBRA COIL 400 COMPARED TO ORBIT/GALAXY FOR TREATMENT OF ANEURYSMS IN THE CEREBROVASCULAR SYSTEM

J. Milburn¹, A.L. Pansara¹, R.C. Martinez², G. Vidal³

¹ *Ochsner Medical Center, Department of Radiology, New Orleans, LA, USA,* ² *Louisiana State University, Department of Neurology, New Orleans, LA, USA,* ³ *Ochsner Medical Center, Department of Neurology, New Orleans, LA, USA*

15:30 - 16.00 *Coffee Break*

Room HZ 2

16:00 - 18:00

Parallel scientific session with introductory invited presentation

Diagnostic advanced MRI-techniques

Chair: E. Hattingen (Germany), I. Pronin (Russia)

Diagnostic advanced MRI-techniques

R. Deichmann (Germany)

USE OF BOLD SEQUENCES AND HYPEROXIA IN THE ASSESSMENT OF BRAIN TUMOR VIABILITY

J. Martinez Barbero¹, A. Luna Alcala¹, L. Alcala Mata¹, T. Martin Noguero¹, J. Sanchez²

¹ *Clinica Las Nieves, Sercosa, Grupo Health Time, Jaen, Spain,* ² *Philips Healthcare España, Madrid, Spain*

SUPERSELECTIVE PCASL - FIRST CLINICAL RESULTS WITH A NOVEL MRI METHOD FOR INDIVIDUAL CHARACTERIZATION OF INTRACEREBRAL PERFUSION

V. Tóth¹, M. Helle², A. Förschler¹, C. Zimmer¹, C. Preibisch¹

¹ *Dep. of Neuroradiology, Klinikum rechts der Isar, Munich, Germany,* ² *Philips Technologie GmbH, Innovative Technologies, Research Laboratories, Hamburg, Germany*

DIFFUSION KURTOSIS IMAGING IN GRADING OF BRAIN GLIOMA MALIGNANCY

A. Tonoyan¹, I. Pronin¹, L. Fadeeva¹, D. Pitskhelauri¹, L. Shishkina¹, A. Ektova¹, F. Grinberg², E. Farrher², V. Kornienko¹

¹ *Burdenko Neurosurgery Institute, Neuroradiology, Moscow, Russia,* ² *Forschungszentrum Juelich, Institute of Neuroscience and Medicine 4, Medical Imaging Physics, Juelich, Germany*

REGIONAL SPECIFICITY OF fMRI, DTI, AND MRS DATA IN SUBSTANTIA NIGRA (SN) FOR CHARACTERISTICS OF THE LEVEL OF COGNITIVE IMPAIRMENT (CI) IN PATIENTS WITH PARKINSON'S DISEASE (PD)

Z. Rozhkova¹, O. Omelchenko¹, I. Karaban², N. Karasevich²

¹ *Medical Clinic BORIS, Department of Radiology, Kiev, Ukraine,* ² *Institute of Gerontology, Department of Extrapramidal Disorders, Kiev, Ukraine*

Sunday, September 29, 2013

USEFULNESS OF BRAIN PERFUSION MAPS OBTAINED WITH ARTERIAL SPIN LABELING IN REFRACTORY EPILEPSY

N. Bargallo¹, A. Sierra², X. Setoain¹, M. Carreño², A. Donaire², J. Rumia²

¹ *CDIC. Hospital Clinic i Provincial, Barcelona, Spain*, ² *Institut de Neurociències, Hospital Clinic i Provincial, Barcelona, Spain*

ARTERIAL SPIN-LABELING MR IMAGING IN MENINGOENCEPHALITIS

T. Noguchi, M. Nishihara, Y. Hara, T. Hirai, H. Irie

Department of Radiology, Faculty of Medicine, Saga University, Saga City, Japan

INTRAVOXEL INCOHERENT MOTION DIFFUSION-WEIGHTED MR IMAGING OF GLIOMAS: FEASIBILITY OF THE METHOD AND INITIAL RESULTS

S. Bisdas¹, C. Roder², C. Braun³, U. Klose¹, E. Ernemann¹

¹ *University of Tübingen, Department of Neuroradiology, Tübingen, Germany*, ² *University of Tübingen, Department of Neurosurgery, Tübingen, Germany*, ³ *University of Tübingen, Department of Neurology, Tübingen, Germany*

POTENTIAL CLINICAL APPLICATIONS OF ULTRA-HIGH-FIELD MRI (7T) OF THE CENTRAL NERVOUS SYSTEM

J. Johnson, J. Polimeni, E. Ratai, B. Keil, L. Wald, S. Stufflebeam, B. Rosen, J. Romero

Massachusetts General Hospital, Boston, MA, USA

Room HZ 3

16:00 - 18:00

Parallel scientific session with introductory invited presentation

White Matter Diseases

Chair: L. Markovic (Denmark)

Diagnostic white matter diseases: how to approach?

F. Bonneville (Toulouse, France)

MAGNETIC CHARACTERISTICS OF MULTIPLE SCLEROSIS MEASURED BY QUANTITATIVE SUSCEPTIBILITY MAPPING (QSM)

Y. Wang, W. Chen, S. Gauthier, T. Liu, J. Communale, A. Gupta

Cornell University, New York, NY, USA

ASSOCIATION OF MR FEATURES AND CLINICAL PRESENTATION, LEVELS OF ADVANCED OXIDATION PROTEIN PRODUCTS AND TOTAL THIOL CONTENT IN PLASMA AND CSF IN PATIENTS WITH CLINICALLY ISOLATED SYNDROME AND RELAPSING REMITTING MULTIPLE SCLEROSIS

D. Stojanov¹, S. Ljubisavljevic², S. Vojinovic², I. Stojanovic³

¹ *Center of Radiology, Clinical Center Nis, Nis, Serbia*, ² *Clinic of Neurology, Clinical Center Nis, Nis, Serbia*, ³ *Institute for Biochemistry, Faculty of Medicine University of Nis, Nis, Serbia*

BRAINSTEM WHITE MATTER LESIONS ON MRI IN PATIENTS WITH TRIGEMINAL NEURALGIA WITHOUT MULTIPLE SCLEROSIS, OUR CASE SERIES AND REVIEW OF LITERATURE

F. D'Arco, A. D'amico, C. Russo, F. Caranci, B. Carotenuto, N. Di Paolo, M. Marseglia, A. Brunetti

University Federico II Department of Diagnostic Imaging and Radiotherapy, Naples, Italy

SUSCEPTIBILITY SIGNAL WITHIN DEMYELINATING PLAQUES IN CLINICALLY ISOLATED SYNDROMES

A. Rovira, C. Auger, M. Tintore, J. Canahuri, G. Santana, C. Montealegre,

G. Arrambide, E. Huerga, R. Mitjana, X. Aymerich, X. Montalban

Hospital Universitari Vall d'Hebron, Barcelona, Spain

Sunday, September 29, 2013

INFLAMMATORY PERFUSION CHANGES CORRELATE WITH EXECUTIVE FUNCTION DEFICITS IN PATIENTS WITH CLINICALLY ISOLATED SYNDROME

E. Papadaki¹, P. Simos², T. Panou³, V. Mastorodemos³, T. Maris⁴, A. Karantanas¹, A. Plaitakis³
¹ University Hospital, Department of Radiology, Heraklion, Greece, ² University Hospital, Department of Psychiatry, Heraklion, Greece, ³ University Hospital, Department of Neurology, Heraklion, Greece, ⁴ University Hospital, Department of Medical Physics, Heraklion, Greece

GLUCOSE METABOLISM IN ADULT-ONSET AUTOSOMAL DOMINANT LEUKODYSTROPHY (ADLD) WITH AUTONOMIC SYMPTOMS

J. Finnsson¹, I. Savitcheva², M. Lubberink⁴, A. Melberg³, R. Raininko¹
¹ Department of Radiology, Uppsala University, Uppsala, Sweden, ² Department of Radiology, Karolinska University Hospital, Huddinge, Stockholm, Sweden, ³ Department of Neurosciences/Neurology, Uppsala University, Uppsala, Sweden, ⁴ Department of Nuclear Medicine & PET, Uppsala University, Uppsala, Sweden

SIGNAL INTENSITY CHANGES IN MEDIAL TEMPORAL LOBE STRUCTURES IN ALZHEIMER DISEASE AND NORMAL AGING AND THEIR CORRELATION WITH ATROPHY AND CLINICAL MEASURES

M. Martucci¹, J. Alonso¹, J. Corral¹, D. Pareto¹, X. Guri¹, A. Palasi², F. Pujadas², C. Auger¹, A. Rovira¹
¹ MR Unit, Radiology Department, Vall d'Hebron University Hospital, Barcelona, Spain, ² Neurology Department, Vall d'Hebron University Hospital, Barcelona, Spain

STRUCTURAL AND FUNCTIONAL CHANGES IN MULTIPLE SCLEROSIS PATIENTS DURING THE RELAPSE WITH MOTOR DISORDERS AND IN THE FOLLOW-UP

S. Kulikova, V. Bryukhov, A. Peresedova, O. Trifonova, M. Krotenkova, I. Zavalishin
Research Center of Neurology RAMS, Moscow, Russia

THE TIMELINE OF MEDIAL TEMPORAL LOBE ATROPHY DEPENDS ON THE CLINICAL SUBTYPE OF MULTIPLE SCLEROSIS - A VOXEL BASED MORPHOMETRY STUDY

L. Kozák¹, A. Iljicsov², M. Simó², D. Bereczki², G. Rudas¹, P. Barsi¹
¹ Semmelweis University, MR Research Center, Budapest, Hungary, ² Semmelweis University, Department of Neurology, Budapest, Hungary

Room HZ 4

16:00 - 18:00

Parallel scientific session with introductory invited presentation

Spinal Imaging

Chair: L. Weise (Germany), M. Muto (Italy)

DTI of the spinal cord (technique and clinical applications)

M. Sasiadek (Poland)

WHAT IS MISSED WHEN REPORTING MRI LUMBAR SPINES - MOST COMMON FALSE NEGATIVE ERRORS AND HOW TO LOWER THEIR INCIDENCE

C. Schorlemmer, E. Thimansson
Telemedicine Clinic, Barcelona, Spain

TUBERCULOUS SPINE - VARIED PRESENTATION

U. Rashid
Post Graduate Medical Institute, Lahore, Pakistan

Sunday, September 29, 2013

DIFFUSION TENSOR IMAGING INDEXES CORRELATE WITH CONVENTIONAL MRI FOR LUMBAR INTERVERTEBRAL DISC DEGENERATION

J. Puig¹, G. Blasco¹, J. Daunis-I-Estadella², X. Molina¹, C. Guergue¹, S. Pedraza¹
¹ Department of Radiology (IDI), Girona Biomedical Research Institute (IDIBGI), Hospital Universitari Dr Josep Trueta, Girona, Spain, ² Department of Computer Science, Applied Mathematics and Statistics, University of Girona, Girona, Spain

SAFETY ASPECT AND OUTCOME IN INTRATHECALLY APPLIED GADOLINIUM CONTAINING CONTRAST MEDIA FOR THE DIAGNOSIS OF INTRACRANIAL HYPOTENSION SYNDROME

F. Donnerstag¹, P. Raab¹, E. Bültmann¹, F. Götz¹, R. Pul², H. Lanfermann¹
¹ Institute of Diagnostic and Interventional Neuroradiology, Hannover Medical School, Hannover, Germany, ² Department of Neurology, Hannover Medical School, Hannover, Germany

DYNAMIC CONTRAST ENHANCEMENT MAGNETIC RESONANCE PERFUSION OF THE SPINAL CORD AND ADJACENT LESIONS

V. Cuvinciu¹, M. Viallon², F. Herrmann³, S. Haller¹, M.I. Vargas¹, K.O. Lovblad¹
¹ University Hospitals of Geneva, Imaging Department, Neuroradiology Unit, Geneva, Switzerland, ² University Hospitals of Geneva, Imaging Department, Radiology Unit, Geneva, Switzerland, ³ University Hospitals of Geneva, Department of Internal Medicine, Rehabilitation and Geriatrics, Geneva, Switzerland

INITIAL EXPERIENCE WITH DOUBLE INVERSION RECOVERY IN THE DETECTION OF MULTIPLE SCLEROSIS LESIONS IN THE CERVICAL CORD: A COMPARISON WITH PROTON DENSITY WEIGHTED AND T2 WEIGHTED SEQUENCES AT 1.5 TESLA

A. Chong, E. Roberts, R.V. Chandra, K. Chuah, S. Stuckey
Monash Medical Centre, Melbourne, Australia

UNDERSTANDING THE BAASTRUP'S DISEASE SPECTRUM: FROM KISSING SPINE TO INTERSPINOUS BURSTITIS

A. Bourgeois, A. Faulkner, J. Boyd, P. Campbell, R. Daker
University of Tennessee Medical Center, Knoxville, TN, USA

Room HZ 5

16:00 - 18:00

Parallel scientific session with introductory invited presentation
Interventional AVM and AVF

Chair: C. Stapf (France), J. Gralla (Switzerland)

Onyx in AVM and AVF: real complication rate

L. Spelle (France)

BRAIN ARTERIOVENOUS MALFORMATION TREATMENT BY VENOUS APPROACH

S. Saleme, D. Ayoub, S. Ponomarjova, J.A. Mejia Nunez, T. Dinh, C. Mounayer
CHU de Limoges, Department of Neuroradiology, Limoges, France

ONYX EMBOLIZATION OF CEREBRAL ARTERIOVENOUS MALFORMATIONS BY MENINGEAL ARTERY APPROACH

H. Nordmeyer, M. Heddier, M. Stauder, P. Schoss, P. Stracke, R. Chapot
Alfried Krupp Hospital, Essen, Germany

Sunday, September 29, 2013

THE RADIOGRAPHIC OUTCOME OF SILENT MICROEMBOLISM ON DIFFUSION-WEIGHTED IMAGING IS IDENTICAL BETWEEN MICROSURGICAL CLIPPING AND ENDOVASCULAR COILING

T. Matsushige¹, Y. Kiura¹, S. Sakamoto¹, T. Okazaki¹, K. Shinagawa¹, N. Ichinose¹, M. Takasu², Y. Akiyama², K. Kurisu¹

¹ Department of Neurosurgery, Graduate School of Biomedical and Health Sciences, Hiroshima University, Hiroshima, Japan, ² Department of Diagnostic Radiology, Hiroshima University Hospital, Hiroshima, Japan

COIL EMBOLIZATION OF ANEURYSMS INCORPORATING A BRANCH INTO THE SAC, SAFETY, DURABILITY, SINGLE CENTER EXPERIENCE

O. Mansour^{1,2,3}, M. Megahed¹

¹ Alexandria University, Interventional Neurology Division, Alexandria, Egypt, ² Tanta University, Neuroradiology Center, Tanta, Egypt, ³ Freiburg Uniklinikum, Eurozentrum, Neuroradiologie Abt., Freiburg, Germany

HYPOGLOSSAL CANAL DAVF: SYSTEMATIC REVIEW ON IMAGING ANATOMY, CLINICAL FINDINGS, AND ENDOVASCULAR MANAGEMENT

S. Meckel¹, S. El Sharifi¹, C. Hader^{1,2}, T.P. Singh³, D. San Millán Ruíz⁴, B. Spittau⁵

¹ University Hospital Freiburg, Neuroradiology, Freiburg, Germany, ² Cantonal Hospital St. Gallen, Neuroradiology, St. Gallen, Switzerland, ³ Sir Charles Gairdner Hospital, Neurological Intervention and Imaging Service of Western Australia (NIISWA), Perth, Australia, ⁴ Hospital of Sion, Valais, Neuroradiology Unit, Sion, Switzerland, ⁵ University of Freiburg, Institute for Anatomy and Cell Biology, Department of Molecular Embryology, Freiburg, Germany

CLINICAL EXPERIENCE AND RESULTS IN A SERIES OF 27 ANEURYSMS TREATED WITH PENUMBRA PC 400 COILS

J. Massó Romero, A. Lüttich Uroz, J. Larrea Peña, E. Pardo Zudaire, A. Masso Ordiozola, S. Cervantes Ibañez

Hospital Donostia San Sebastián Servicio de Neuroradiología Paseo dr begiristain Donostia, San Sebastián, Spain

VENO-SINUS HEMODYNAMICS OF DAVF: THE CLINICAL IMPLICATION OF QUANTITATIVE DSA

W. Guo¹, C.J. Lin^{1,2}, S.C. Hung^{1,2}, F.C. Chang^{1,2}, W.F. Chu¹, H.M. Wu^{1,2}, C.B. Luo^{1,2}, W.Y. Chung^{1,3}

¹ Taipei Veterans General Hospital, Department of Radiology, Taipei, Taiwan, ² School of Medicine, National Yang-Ming University, Taipei, Taiwan, ³ Taipei Veterans General Hospital, Department of Neurosurgery, Taipei, Taiwan

RESOLUTIVE ENDOVASCULAR TREATMENT OF CAROTID-CAVERNOUS FISTULA WITH DETACHABLE BALLONS

J. Figueroa, A. Martinez-ponce De Leon

University Hospital Jose Eleuterio González UANL - Neurosurgery Service and Endovascular Neurological Therapy, Monterrey, Mexico

SAFETY AND EFFICACY OF A NEW DEVICE FOR THE TREATMENT OF WIDE NECK BIFURCATION ANEURYSMS (PCONUS) - PRELIMINARY EXPERIENCE

M. Aguilar Pérez¹, W. Kurre¹, S. Felber², E. Donauer³, N. Hopf⁴, H. Bätzner⁵, H. Henkes¹

¹ Klinikum Stuttgart, Department of Neuroradiology, Stuttgart, Germany, ² Stiftungsklinikum Mittelrhein, Department of Neuroradiology, Koblenz, Germany, ³ Mediclin Krankenhaus, Department of Neurosurgery, Plau Am See, Germany, ⁴ Klinikum Stuttgart, Department of Neurosurgery, Stuttgart, Germany, ⁵ Klinikum Stuttgart, Department of Neurology, Stuttgart, Germany

SCIENTIFIC PROGRAM

Monday, September 30, 2013

37th ESNR Annual Meeting

Room HZ 2

08:00 - 09:00

REFRESHER COURSE DIAGNOSTIC: Dementias beyond Alzheimer and psychiatric disorders

Chair: N. Sadeghi (Belgium)

Dementias beyond Alzheimer

P. Scheltens (The Netherlands)

Advanced imaging in psychosis

S. Weidauer (Germany)

Advanced imaging in vertigo

Z. Merhemc (Bosnia and Herzegovina)

Room HZ 3

08:00 - 09:00

REFRESHER COURSE INTERVENTIONAL: SAH and vasospasm

Chair: V. Seifert (Germany)

Imaging assessment of patients with cerebral vasospasm after SAH

J. Byrne (United Kingdom)

Vasospasm: clinical concepts, therapeutic options and evidence

H. Vatter (Germany)

Interventional treatment of vasospasm: indication and how to do it

J. Berkefeld (Germany)

Room HZ 2

09:00 - 10:00

Future MRI

Chair: R. Deichmann (Germany)

Possibilities and limitations of functional MRI

R. Göbel (The Netherlands)

Clinical application ahead: quantitative imaging and multinuclear spectroscopy

E. Hattingen (Germany)

Real-time MRI: recent advances and future potential

J. Frahm (Germany)

Room HZ 3

09:00 - 10:00

Parallel scientific session

Stroke Aneurysm/AVM

Chair: J. Byrne (United Kingdom), M.S. Khangure (Australia)

RECONSTRUCTIVE THERAPY WITH STENT FOR PARTIALLY THROMBOSED ANEURYSMS IN THE POSTERIOR CIRCULATION

T. Nakazawa, K. Higuchi, T. Yokoi, M. Tanimoto, H. Kimura, K. Takagi, N. Nitta, J. Jito, T. Fukami, K. Nozaki

Shiga University of Medical Science, Otsu, Japan

IS PREOPERATIVE STATIN THERAPY EFFECTIVE ON REDUCING DWI POSITIVE MICROEMBOLISM DURING COILING OF UNRUPTURED CEREBRAL ANEURYSMS?

T. Matsushige¹, Y. Kiura¹, S. Sakamoto¹, T. Okazaki¹, K. Shinagawa¹, N. Ichinose¹, M. Takasu², Y. Akiyama², K. Kurisu¹

¹ Department of Neurosurgery, Graduate School of Biomedical and Health Sciences, Hiroshima University, Hiroshima, Japan, ² Department of Diagnostic Radiology, Hiroshima University Hospital, Hiroshima, Japan

Monday, September 30, 2013

RELIABILITY OF USING QUANTITATIVE DIGITAL SUBTRACTION ANGIOGRAPHY TO MONITOR CEREBRAL HEMODYNAMIC IN PATIENTS WITH SUBARACHNOID HEMORRHAGE-A PILOT STUDY

C. Lin¹, W. Guo¹, S. Hung¹, C. Lin², B. Hsu², W. Chu¹

¹ Taipei Veterans General Hospital, Radiology Department, Taipei, Taiwan, ² Taipei Veterans General Hospital, Neurosurgery Department, Taipei, Taiwan

TREATMENT OF DISSECTING ANEURYSMS OF THE POSTERIOR INFERIOR CEREBELLAR ARTERY: ANATOMICAL CONSIDERATIONS AND CLINICAL CONSEQUENCES

R. Van Den Berg, T.C. Doorschodt, M.E.S. Sprengers, W.P. Vandertop

Academic Medical Center, Amsterdam, Netherlands

ENDOVASCULAR REPAIR OF POSTERIOR COMMUNICATING ARTERY ANEURYSMS, ASSOCIATED WITH OCULOMOTOR NERVE PALSY: A REVIEW OF NERVE RECOVERY

M. Sheehan, S. Looby

Beaumont Hospital, Department of Radiology, Dublin, Ireland

INTRA-ANEURYSMAL FLOW DISRUPTION: A NEW APPROACH FOR THE ENDOVASCULAR TREATMENT OF INTRACRANIAL ANEURYSMS. FRENCH CLINICAL EXPERIENCE

L. Pierot¹, A.C. Januel², H. Raoult³, L. Spelle⁴, C. Papagiannaki⁵, H. Desal⁶, P. Courtheoux⁷, K. Kadziolka¹, J.Y. Gauvrit³, J. Moret⁴, D. Herbreteau⁵, C. Cognard²

¹ CHU Reims, Reims, France, ² CHU Toulouse, Toulouse, France, ³ CHU Rennes, Rennes, France, ⁴ Hopital Beaujon, Clichy/Paris, France, ⁵ CHU Tours, Rennes, France, ⁶ CHU Nantes, Nantes, France, ⁷ CHU Caen, Caen, France

Room HZ 15

09:00 - 11:00 **Workshop "Stroke treatment"**

J. Berkefeld (Germany), G. Schroth (Switzerland)

Room HZ 5

09:00 - 11:30 **Workshop "MR spectroscopy: what does that have to do with alcohol?"**

G. Ende (Germany), U. Pilatus (Germany)

10:00 - 10:30 *Coffee Break*

Room HZ 2

10:30 - 11:30 **DIAGNOSTIC SPECIAL FOCUS - Inflammatory disease**

Chair: G. Wilms (Belgium)

MRI in the diagnosis of MS: challenges and new evidences

A. Rovira (Spain)

Congenital infections

A. Rossi (Italy)

Imaging of vasculitis

P. Sundgren (Sweden)

SCIENTIFIC PROGRAM

Monday, September 30, 2013

Room HZ 3

10:30 - 11:30

INTERVENTIONAL SPECIAL FOCUS - Clinical outcome after interventional procedures

Chair: D. Rüfenacht (Switzerland)

New and rare techniques for aneurysm treatment: how to manage the risk of complications

I. Saatci (Turkey)

Aneurysms and AV-fistulae with cranial nerve deficits

C. Cognard (France)

Incidental aneurysms and vascular malformations

C. Stapf (France)

Room HZ 2

11:30 - 13:00

Neuroradiology: from the past to the future - Dedicated to Hans Hacker

Chair: F.E. Zanella (Germany)

Neuroanatomy and high-resolution MRI

R. Göbel (The Netherlands)

Imaging in neuroscience

W. Singer (Germany)

Perspectives for neuroradiologists

M. Leonardi (Italy)

Room HZ 3

11:30 - 13:00

Parallel scientific session

Brain tumors 1

Chair: R. Colen (USA)

COMPARISON OF ARTERIAL SPIN LABELLING AND DYNAMIC SUSCEPTIBILITY-WEIGHTED CONTRAST-ENHANCED MR PERFUSION IMAGING IN BRAIN TUMOURS

Y. Ozsunar Dayanir¹, S. Ata¹, Y. Durum¹, M. Turgut²

¹ Adnan Menderes University Faculty of Medicine, Department of Radiology, Aydin, Turkey, ² Adnan Menderes University Faculty of Medicine, Department of Neurosurgery, Aydin, Turkey

PROTON MR SPECTROSCOPY COULD BE USEFUL IN THE DIAGNOSIS OF PRIMARY CENTRAL NERVOUS SYSTEM LYMPHOMA (PCNSL)

P. Mora¹, M. Cos², A. Camins², A. Muntané¹, C. Aguilera², C. Majós²

¹ Neuroradiology and Neurointerventional Department, Hospital Universitari de Bellvitge, Barcelona, Spain, ² Institut Diagnòstic per la Imatge (IDI), Hospital Universitari de Bellvitge, Barcelona, Spain

PH CHANGES IN RECURRENT GLIOBLASTOMAS DURING BEVACIZUMAB MEASURED WITH 31P MR SPECTROSCOPY

U. Pilatus¹, V. Voelker¹, M. Hardt¹, O. Baehr², E. Hattingen¹

¹ Neuroradiology, Goethe University, Frankfurt, Germany, ² Dr. Senckenberg Institute of Neurooncology, Goethe University, Frankfurt, Germany

FACTORS CONTRIBUTING TO ITSS-MORPHOLOGY IN PATIENTS WITH GLIOBLASTOMA MULTIFORME

D. Fahrendorf¹, V. Hesselmann¹, W. Schwindt¹, J. Wölfer², H. Kooijman³, H. Kugel¹, W. Heindel¹, A. Bink¹

¹ University Hospital Münster, Department of Clinical Radiology, Münster, Germany,

² University Hospital Münster, Department of Neurosurgery, Münster, Germany, ³ Philips Healthcare, Clinical Application, Hamburg, Germany

Monday, September 30, 2013

BENEFITS OF CONTRAST-ENHANCED SWI IN PATIENTS WITH GLIOBLASTOMA MULTIFORME

D. Fahrendorf¹, W. Schwindt¹, J. Wölfer², A. Jeibmann³, H. Kooijman⁴, H. Kugel¹, O. Grauer⁵, W. Heindel¹, V. Hesselmann¹, A. Bink¹

¹ University Hospital Münster, Department of Clinical Radiology, Münster, Germany,

² University Hospital Münster, Department of Neurosurgery, Münster, Germany, ³ University Hospital Münster, Institute of Neuropathology, Münster, Germany, ⁴ Philips Healthcare, Clinical Application, Hamburg, Germany, ⁵ University Hospital Münster, Department of Neurology, Inflammatory Disorders of the Nervous System and Neurooncology, Münster, Germany

DIFFERENTIATION OF VASOGENIC EDEMA FROM TUMOR-INFILTRATED EDEMA USING DTI, RCBV AND MR SPECTROSCOPY. A PROSPECTIVE STUDY OF 25 PATIENTS

F. De Belder¹, M. De Belder², C. Venstermans¹, J. Van Goethem¹, L. van den Hauwe¹, T. Van Der Zijden¹, M. Voormolen¹, P.M. Parizel¹

¹ Antwerp University Hospital, Radiology, Antwerp, Edegem, Belgium, ² Ghent University, Department of Experimental Psychology, Ghent, Belgium

CORRELATION OF EXTRAVASCULAR EXTRACELLULAR SPACE OF TREATED GLIOBLASTOMAS BETWEEN DYNAMIC CONTRAST ENHANCEMENT MAGNETIC RESONANCE PERFUSION AND DIFFUSION TENSOR IMAGING

V. Cuvinciu¹, A. Varoquaux², M. Viallon², O. Gurer², I. Barnaure Nachbar², M.I. Vargas¹, S. Haller¹, K.O. Lovblad¹

¹ University Hospitals of Geneva, Imaging Department, Neuroradiology Unit, Geneva, Switzerland,

² University Hospitals of Geneva, Imaging Department, Radiology Unit, Geneva, Switzerland

MR PERFUSION IN AND AROUND THE CONTRAST-ENHANCEMENT OF PRIMARY CNS LYMPHOMAS

S. Blasel¹, A. Jurcoane¹, O. Baehr², L. Weise³, P.N. Harter⁴, E. Hattingen¹

¹ Institute of Neuroradiology, Goethe University Hospital Frankfurt, Frankfurt, Germany, ² Dr.

Senckenberg Institute of Neurooncology, Goethe-University Hospital Frankfurt, Frankfurt,

Germany, ³ Department of Neurosurgery, Goethe-University Hospital Frankfurt, Frankfurt,

Germany, ⁴ Edinger Institute, Institute of Neurology, Goethe-University Frankfurt, Frankfurt, Germany

ASSESSMENT OF PROGRESSION-FREE-SURVIVAL AND THERAPY RESPONSE IN GLIOBLASTOMAS BY INTRATREATMENT DYNAMIC CONTRAST-ENHANCED MRI

S. Bisdas¹, U. Smrdel², F. Bajrovic³, K. Surlan-Popovic⁴

¹ University of Tübingen, Department of Neuroradiology, Tübingen, Germany, ² Oncology

Institute, Department of Radiation Therapy, Ljubljana, Slovenia, ³ University of Ljubljana,

Department of Neurology, Ljubljana, Slovenia, ⁴ University of Ljubljana, Department of

Neuroradiology, Ljubljana, Slovenia

Room HZ 4

11:30 - 13:00

Parallel scientific session

Pediatrics

Chair: A. Rossi (Italy)

THE NEURONAL CORRELATES OF MIRROR ILLUSION IN CHILDREN WITH HEMIPARESIS: A PILOT STUDY USING FUNCTIONAL MRI

C. Weisstanner¹, S. Saxer^{4,5}, A. Kaelin-Lang², C.J. Newman³, M. Zbinden¹, R. Wiest¹, M. Steinlin⁴, S. Grunt⁴

¹ University Institute of Diagnostic and Interventional Neuroradiology, University Hospital, Bern,

Switzerland, ² Department of Neurology, University Hospital, Bern, Switzerland, ³ Division

of Neuropaediatrics and Rehabilitation, Nestlé Hospital CHUV, Lausanne, Switzerland,

⁴ Division of Neuropaediatrics, Development and Rehabilitation, Children University Hospital,

Bern, Switzerland, ⁵ Institute of Human Movement Sciences and Sport, ETH Zürich, Zürich, Switzerland

Monday, September 30, 2013

DIFFERENT PATTERNS OF CEREBELLAR ABNORMALITY AND HYPOMYELINATION BETWEEN POLR3A AND POLR3B MUTATIONS

H. Tada¹, J. Takanashi², H. Mori³, H. Terada⁴, A. J. Barkovich⁵

¹ Department of Pediatrics, Chibaken Saiseikai Nrashino Hospital, Narashino, Japan, ² Department of Pediatrics, Kameda Medical Center, Kamogawa, Japan, ³ Department of Radiology, University of Tokyo, Tokyo, Japan, ⁴ Department of Radiology, Toho University Sakura Medical Center, Sakura, Japan, ⁵ Department of Radiology and Biomedical Imaging, University of California San Francisco, San Francisco, CA, USA

DIFFERENT IMAGING ASPECTS IN MALFORMATIONS OF CORTICAL DEVELOPMENT DEPENDING ON MYELINATION AND AGE - PICTORIAL ESSAY AND LITERATURE REVIEW

M. Sarpi, L. Silva, L. Godoy, H. Lee, M. Docema, M. Martin, T. Lyra, D. Delgado
Hospital Sírío Libanês, São Paulo, Brazil

RADIOLOGICAL AND CLINICAL MANIFESTATIONS OF MEGALENCEPHALY-CAPILLARY MALFORMATION (M-CM) SYNDROME

A. Sanchez-Montanez¹, P.A. Parra Ramirez¹, S. Boronat Guerrero², I. Delgado Alvarez¹, P. Cano Granda³, E. Vazquez Mendez¹

¹ Vall d'Hebron University Hospital, Diagnostic Imaging, Barcelona, Spain, ² Vall d'Hebron University Hospital, Pediatric Neurology, Barcelona, Spain, ³ Vall d'Hebron University Hospital, Neurosurgery, Barcelona, Spain

RESTRICTED DIFFUSION IN CHILDREN, SECONDARY TO CEREBRAL HYPOXIA: IDENTIFYING MRI SIGNS OF GOOD NEUROLOGICAL OUTCOME

N. Pyatigorskaya, I. Haegy, R. Richard, D. Siahou, J. Bataille, R. Carlier
Raymond Poincaré, Garches, France

CONVENTIONAL MAGNETIC RESONANCE IMAGING IN THE DIFFERENTIATION BETWEEN HIGH AND LOW GRADE BRAIN TUMOURS IN PAEDIATRIC PATIENTS

L. Porto¹, A. Jurcoane¹, D. Schwabe², E. Hattingen¹

¹ Goethe University, Neuradiology Department, Frankfurt, Germany, ² Goethe University, Pediatric oncology Department, Frankfurt, Germany

VALUE OF 18F-DOPA PET/MRI FUSION IN PEDIATRIC PATIENTS WITH SUPRATENTORIAL INFILTRATIVE ASTROCYTOMAS

G. Morana¹, A. Piccardo², M.L. Garre³, M. Puntoni⁴, P. Nozza⁵, A. Cama⁶, D. Zefiro⁷, M. Cabria², A. Rossi¹

¹ Istituto G. Gaslini - U.O. Neuroradiologia, Genova, Italy, ² Ospedali Galliera - S.C Medicina Nucleare, Genova, Italy, ³ Istituto G. Gaslini - U.O. Neuro-oncologia, Genova, Italy, ⁴ Ospedali Galliera - Direzione Scientifica, Genova, Italy, ⁵ Istituto G. Gaslini - U.O. Anatomia Patologica, Genova, Italy, ⁶ Istituto G. Gaslini - U.O. Neurochirurgia, Genova, Italy, ⁷ Ospedali Galliera - S.C. Fisica Sanitaria, Genova, Italy

MR IMAGING FINDINGS IN PEDIATRIC HEAD AND NECK RHABDOMYOSARCOMA

I. Delgado Alvarez, J.L. Horteaga Garcia, A. Sanchez Montanez, L. Gros Subias, E. Vazquez Mendez

Hospital Universitario Vall d'Hebron, Barcelona, Spain

AUDIO-VISUAL REAR-PROJECTION SYSTEM IN MAGNETIC RESONANCE FOR PEDIATRIC POPULATION

A. Sanchez-Montanez, I. Delgado, J.P. Salazar, J.F. Corral, E. Vazquez, G. Enriquez
Vall d'Hebron University Hospital, Diagnostic Imaging, Barcelona, Spain

13:00 - 14:00 Lunch

SCIENTIFIC PROGRAM

Monday, September 30, 2013

Room HZ 2

14:00 - 15:00 **ESNR General Assembly**

Room HZ 2

15:00 - 18:00 **ESNR Interventional Hot Topics**

Chair: H. Brückmann (Germany)

First results of ARUBA: end of invasive AVM-treatment? Neurological perspective

C. Stapf (France)

Lessons to learn from ARUBA: consequences for interventional treatment?

R. Chapot (Germany)

Discussion

Interventional stroke treatment: are we the good guys?

R. von Kummer (Germany)

Interventional stroke treatment: perspectives for better study results

J. Gralla (Switzerland)

Discussion

Clipping vs. coiling still a matter of debate? Neurosurgical perspective

V. Seifert (Germany)

Coiling after ISAT: a single lucky study or basis for reliable clinical application?

A. Molyneux (United Kingdom)

Discussion

New materials and perspectives for interventional aneurysm treatment

I. Szikora (Hungary)

Do we need better rules for device approval in Europe?

E. Houdart (France)

Discussion

Room HZ 3

15:00 - 16:30 **Parallel scientific session**

Brain tumors 2

Chair: P. Sundgren (Sweden)

PREOPERATIVE DIFFERENTIATION OF HIGH GRADE GLIOMAS, METASTASES AND PRIMARY CENTRAL NERVOUS SYSTEM LYMPHOMAS USING PERFUSION AND DIFFUSION WEIGHTED MR IMAGING

*A. Zimny, M. Neska-Matuszewska, J. Bladowska, M. Guzinski, M. Sasiadek
Wroclaw Medical University, Department of Radiology, Wroclaw, Poland*

COMPARISON OF THREE DIFFERENT MR-PERFUSION TECHNIQUES AND MR-SPECTROSCOPY FOR DISTINGUISHING RECURRENT HIGH-GRADE GLIOMAS FROM RADIATION INJURY

A. Seeger¹, C. Braun², F. Paulsen³, M. Skardelly⁴, U. Ernemann¹, S. Bisdas¹

¹ Diagnostic and Interventional Neuroradiology, Tuebingen, Germany, ² Department of Neurology, Tuebingen, Germany, ³ Department of Radiation Oncology, Tuebingen, Germany, ⁴ Department of Neurosurgery, Tuebingen, Germany

Monday, September 30, 2013

**INTERNAL CAROTID ARTERIAL SHIFT AFTER TRANSSPHEOIDAL SURGERY
IN PITUITARY ADENOMAS WITH CAVERNOUS SINUS INVASION**

Y. Sasagawa¹, O. Tachibana¹, M. Doai², T. Akai¹, H. Tonami², H. Iizuka¹

¹ Department of Neurosurgery, Kanazawa Medical University, Ishikawa, Japan, ² Department of Diagnostic and Therapeutic Radiology, Kanazawa Medical University, Ishikawa, Japan

**IMAGING EVALUATION OF GLIOBLASTOMA MULTIFORME (GBM) DURING TREATMENT
WITH AVASTIN® (BEVACIZUMAB) - A DIVERSITY OF FINDINGS YET TO BE UNDERSTOOD**

M. Sarpi, T. Lyra, L. Godoy, D. Delgado, M. Docema, H. Lee, M. Martin, L. Silva

Hospital Sirio Libanês, São Paulo, Brazil

**MRI FEATURES OF MULTIFOCAL AND MULTICENTRIC GBM TO AID DIFFERENTIATION
FROM CEREBRAL METASTASES AND PRIMARY CNS LYMPHOMA**

E. Ryan, N. Adams, P. Brennan, M. Thornton, A. O'Hare, S. Looby

Department of Neuroradiology, Beaumont Hospital, Dublin, Ireland

**GROWTH PATTERNS OF GLIOBLASTOMA: COMBINED VISUALIZATION OF ADC
DIFFUSION MAPS AND CBV PERFUSION MAPS**

A. Radbruch¹, K. Deike¹, M. Graf², C. Reimer¹, B. Wiestler³, R. Floca², W. Wick³,
M. Bendszus¹, S. Heiland¹

¹ University of Heidelberg, Department of Neuroradiology, Heidelberg, Germany, ² German Cancer Research Center, Department of Radiology, Heidelberg, Germany, ³ University of Heidelberg, Department for Neurooncology, Heidelberg, Germany

**DIFFERENTIATION OF PSEUDOPROGRESSION AND REAL PROGRESSION
IN GLIOBLASTOMA USING ADC PARAMETRIC RESPONSE MAPS**

A. Radbruch¹, C. Reimer¹, M. Graf², J. Fladt¹, K. Deike¹, R.O. Floca², S. Heiland¹,
H.P. Schlemmer², W. Wick³, B. Wiestler³

¹ University of Heidelberg, Department of Neuroradiology, Heidelberg, Germany, ² German Cancer Research Center, Department for Radiology, Heidelberg, Germany, ³ University of Heidelberg, Department of Neurooncology, Heidelberg, Germany

**INTRAVOXEL INCOHERENT MOTION MR IMAGING IN GLIOBLASTOMA: COMPARISON
WITH DYNAMIC SUSCEPTIBILITY CONTRAST-ENHANCED AND IMPACT ON SURVIVAL
PREDICTION**

J. Puig¹, J. Sánchez-González², G. Blasco¹, J. Daunis-I-Estadella³, M. Essig⁴, R. Jain⁵,
S. Pedraza¹

¹ Department of Radiology (IDI), Girona Biomedical Research Institute (IDIBGI), Hospital Universitari Dr Josep Trueta, Girona, Spain, ² Philips Ibérica, Madrid, Spain, ³ Department of Computer Science, Applied Mathematics and Statistics, Girona, Spain, ⁴ Diagnostic Radiology and Neuroradiology, Department of Neuroradiology, University of Erlangen, Erlangen, Germany, ⁵ Division of Neuroradiology, Department of Radiology, Henry Ford Health System, Detroit, MI, USA

**BLOOD POOL CONTRAST AGENT MR ANGIOGRAPHY TO ASSESS GLIOBLASTOMA
VASCULARITY: FEASIBILITY AND CORRELATION WITH SURVIVAL**

J. Puig¹, G. Blasco¹, J. Daunis-I-Estadella², S. Remollo¹, D. Hernández¹,

J. Sánchez-González³, M. Essig⁴, R. Jain⁵, S. Pedraza¹

¹ Department of Radiology (IDI), Girona Biomedical Research Institute (IDIBGI), Hospital Universitari Dr Josep Trueta, Girona, Spain, ² Department of Computer Science, Applied Mathematics and Statistics, University of Girona, Girona, Spain, ³ Philips Iberica, Madrid, Spain, ⁴ Diagnostic Radiology and Neuroradiology, Department of Neuroradiology, University of Erlangen, Erlangen, Germany, ⁵ Division of Neuroradiology, Department of Radiology, Henry Ford Health System, Detroit, MI, USA

SCIENTIFIC PROGRAM

Monday, September 30, 2013

Room HZ 4

15:00 - 16:30

Paediatrics - Joint Session with the American Society of Pediatric Neuroradiology
Monothematic mini-course "Advances in the understanding of brain malformations"

Chair: A. Rossi (Italy), D. Shaw (USA)

Antenatal MRI: pushing the edge for early recognition

A. Righini (Italy)

DTI for brain malformations: does it help?

T. A. Huisman (USA)

Genetic/neuroradiological correlations in 2013

N. Girard (France)

Hindbrain / midbrain malformations: the new classification

A.J. Barkovich (USA)

Discussion

Room HZ 5

15:00 - 16:30

Parallel scientific session with introductory invited presentation

Spine

Chair: M. Muto (Italy), J. Walecki (Poland)

MRI of peripheral nerves and plexuses: imaging techniques and key findings

M. Pham (Germany)

Interventional spine: percutaneous treatment of disc and bone

M. Muto (Italy)

EFFICACY AND UTILITY OF CT-GUIDED SPINAL BIOPSY AS A DIAGNOSTIC TOOL

R. Brennan, A. O'Hare, J. Thornton, P. Brennan, S. Looby

Beaumont Hospital, Department of Academic Radiology, Dublin, Ireland

BONE MINERAL DENSITY MEASUREMENTS OF THE SPINE DERIVED FROM SAGITTAL REFORMATIONS OF MDCT

J. Bauer¹, T. Baum², C. Zimmer¹

¹ *Dep. of Neuroradiology, TUM, Munich, Germany,* ² *Dep. of Radiology, Munich, Germany*

IMPROVING THE ACCURACY OF TRANSPEDICULAR SCREW PLACEMENT IN THE LUMBAR SPINE WITH 3-D STEREOTACTIC NAVIGATION: A REVIEW OF 518 CONSECUTIVE PATIENTS

A. Bourgeois, A. Faulkner, J. Gash, W. Reid

University of Tennessee Medical Center, Knoxville, TN, USA

Monday, September 30, 2013

Room HZ 15

15:00 - 16:30

Parallel scientific session with introductory invited presentation

Head and neck

Chair: M. Mack (Germany), S. Kösling (Germany)

Diagnostic head and neck: vascular lesions temporal bone

S. Kösling (Germany)

ACUTE TENSION ORBITAL EMPHYSEMA: MECHANISM AND TREATMENT WITH NEEDLING DECOMPRESSION

A. Simonovich¹, S. Levartovsky², W. Wehbby², E. Aloni²

¹ Barzilai Medical Center, Radiology Department, Faculty of Sciences at the Ben Gurion University of the Negev, Israel, Ashkelon, Israel, ² Barzilai Medical Center, Ophthalmology Department, Faculty of Sciences at the Ben Gurion University of the Negev, Israel, Ashkelon, Israel

COMPARISON OF ECHO-PLANAR DIFFUSION-WEIGHTED MRI AND HIGH-RESOLUTION CT IN THE STUDY OF PEDIATRIC CHOLESTEATOMA

A. Sanchez-Montanez¹, J.P. Salazar¹, F. Pumarola², I. Delgado¹, M. Pellicer², E. Martinez³, E. Vazquez¹

¹ Vall d'Hebron University Hospital, Diagnostic Imaging, Barcelona, Spain, ² Vall d'Hebron University Hospital, ENT Surgery, Barcelona, Spain, ³ Vall d'Hebron University Hospital, Pathology Department, Barcelona, Spain

DIAGNOSTIC VALUE OF 3TESLA HIGH RESOLUTION IMAGING OF THE TEMPORAL BONE IN CI CANDIDATES

P. Raab¹, F. Götz¹, S. Lyutenski², E. Bültmann¹, T. Lenarz², H. Lanfermann¹, A. Giesemann¹

¹ Hannover Medical School, Neuroradiology, Hannover, Germany, ² Hannover Medical School, Department of ENT, Hannover, Germany

NEW PRE-SURGICAL GRADING SYSTEM FOR ACTIVE MIDDLE EAR IMPLANTS IN PATIENTS WITH CONGENITAL AURAL ATRESIA

C. Mohr¹, G. Sprinzl², G. Widmann³, D. Petersen¹, B. Wollenberg⁴, H. Frenzel⁴

¹ Institute of Neuroradiology, University Hospital Schleswig, Holstein Lübeck, Lübeck, Germany, ² Department of Otorhinolaryngology, University Hospital Innsbruck, Innsbruck, Germany, ³ Department of Radiology, University Hospital Innsbruck, Innsbruck, Germany, ⁴ Department of Otorhinolaryngology and Facial Plastic Operations, University Hospital Schleswig, Holstein Lübeck, Lübeck, Germany

NASOPHARYNGEAL CANCER, A NEURORADIOLOGICAL DIAGNOSIS.

HOW OFTEN IS SKULL BASE AFFECTED?

B. Kress¹, S. Babu², N. Ravindranathan³, P. Varghese⁴, A. Gottschalk^{1,4}

¹ Institute of diagnostic and interventional Neuroradiology, Krankenhaus Nordwest, Frankfurt, Germany, ² The Brunei Cancer Center, Bandar Seri Beghawan, Brunei, ³ Department of oro-maxilla-facial surgery, Ripas Hospital, Bandar Seri Beghawan, Brunei, ⁴ Department of diagnostic Neuroradiology, Bandar Seri Beghawan, Brunei

HIGH-RESOLUTION DIFFUSION-WEIGHTED IMAGING USING READOUT-SEGMENTED ECHO-PLANAR IMAGING IN THE DIAGNOSIS OF TEMPORAL BONE ESPECIALLY FOR MIDDLE EAR CHOLESTEATOMAS

T. Kodama¹, T. Yano¹, S. Tamura¹, D. Porter²

¹ Faculty of Medicine, University of Medicine, Department of Radiology, Miyazaki, Japan, ² Siemens AG - Healthcare Sector, Erlangen, Germany

16:30 - 17:00

Coffee Break

Monday, September 30, 2013

Room HZ 3

17:00 - 18:30

Parallel scientific session

Stroke recanalization

Chair: I. Saatci (Turkey)

MULTIMODAL APPROACH IN THE INTRA-ARTERIAL TREATMENT OF ACUTE ISCHEMIC STROKE

E. Puglielli¹, M. Varrassi¹, M. Fuschi¹, V. Di Egidio²

¹ *Interventional and Vascular Radiology, G. Mazzini Hospital, Teramo, Italy,* ² *General and Interventional Radiology, S. Spirito Hospital, Pescara, Italy*

SUBARACHNOID HAEMORRHAGE AFTER MECHANICAL INTRA-ARTERIAL THROMBECTOMY IN ACUTE ISCHEMIC STROKE: IMAGING FINDINGS AND CLINICAL SIGNIFICANCE

O. Nikoubashman¹, M. Gindullis², K. Frohnhofen¹, R. Pjontek¹, M. Brockmann¹, A. Reich², J. Schulz², M. Wiesmann¹

¹ *Klinik für Diagnostische und Interventionelle Neuroradiologie, Uniklinik Aachen, Aachen, Germany,* ² *Klinik für Neurologie, Uniklinik Aachen, Aachen, Germany*

IMPORTANCE OF PRE-TREATMENT NEUROIMAGING IN IDENTIFYING ACUTE STROKE PATIENTS WITH LARGE INFARCTS WHO ARE UNLIKELY TO RESPOND TO IA THERAPY

D. Frei¹, A. Yoo², D. Heck³, F. Hellinger II⁴, V. Mccollum⁵, D. Fiorella⁶, A.S. Turkli III⁷, T. Malisch⁸, O. Zaidat⁹, Z. Chaudry², R. Gonzalez², L. Barraza¹⁰, S.P. Sit¹⁰, A. Bose¹⁰

¹ *Swedish Medical Center, Englewood, CO, USA,* ² *Massachusetts General Hospital, Boston, MA, USA,* ³ *Forsyth Medical Center, Winston-salem, NC, USA,* ⁴ *Florida Hospital, Orlando, FL, USA,* ⁵ *Mercy Health Center, Oklahoma City, OK, USA,* ⁶ *Stony Brook Medical Center, Stony Brook, NY, USA,* ⁷ *Medical University of South Carolina, Charleston, SC, USA,* ⁸ *Alexian Brothers Medical Center, Elk Grove Village, IL, USA,* ⁹ *Medical College of Wisconsin, Milwaukee, WI, USA,* ¹⁰ *Penumbra, Inc., Alameda, CA, USA*

LONG TERM OUTCOME AFTER INTRACRANIAL ANGIOPLASTY AND STENTING FOR ATHEROSCLEROTIC DISEASE

W. Kuker, U. Schulz, D. Briley, P. Rothwell

Nuffield Department of Clinical Neuroscience, University of Oxford, Oxford, United Kingdom

ENDOVASCULAR TREATMENT IN "BENIGN" INTRACRANIAL HYPERTENSION.

CLINICAL RESULT AND LONG-TERM FOLLOW-UP

M. Aguilar Pérez¹, K. Kurre¹, S. Fischer¹, D. Horward-Rizea¹, R. Unsöld², H. Bätzner³, H. Henkes¹

¹ *Klinikum Stuttgart, Department of Neuroradiology, Stuttgart, Germany,* ² *Privatpraxis für Augenheilkunde, Düsseldorf, Germany,* ³ *Klinikum Stuttgart, Department of Neurology, Stuttgart, Germany*

SIMPLE AND EASY WAY USING TIME-INTENSITY CURVE OF PERFUSION-WEIGHTED IMAGES TO FIND SALVAGEABLE PENUMBRA IN STROKE PATIENTS WITHIN 3.5 HOURS OF THE ONSET DUE TO THE CAROTID AND MIDDLE CEREBRAL ARTERY OCCLUSION

T. Mori, T. Iwata, Y. Miyazaki, S. Kasakura, Y. Tanno, K. Yoshioka

Shonan Kamakura General Hospital Stroke Center, Kamakura, Japan

PERIINTERVENTIONAL SAH DURING MECHANICAL THROMBECTOMY WITH STENTRETRIEVERS IN ACUTE STROKE. A RETROSPECTIVE CASE-CONTROL STUDY

U. Yilmaz¹, S. Walter², H. Körner¹, P. Papanagiotou³, C. Roth³, A. Simgen¹, S. Behnke², A. Ragoschke-Schumm², K. Fassbender², W. Reith¹

¹ *Saarland University Hospital, Department of Neuroradiology, Homburg, Germany,* ² *Saarland University Hospital, Department of Neurology, Homburg, Germany,* ³ *Klinikum Bremen Mitte, Department of Neuroradiology, Bremen, Germany*

Monday, September 30, 2013

THROMBUS DENSITY DOES NOT PREDICT ANGIOGRAPHIC RESULTS OF MECHANICAL THROMBECTOMY WITH STENTRETRIEVERS

U. Yilmaz¹, C. Roth², W. Reith¹, P. Papanagiotou²

¹ Saarland University Hospital, Department of Neuroradiology, Homburg, Germany, ² Klinikum Bremen Mitte, Department of Neuroradiology, Bremen, Germany

SUSEPTIBILITY WEIGHTED IMAGING (SWI) TO IDENTIFY IRREVERSIBLE INFARCTION

E. Tsai¹, H.W. Kao², Y. Tsui³, C. Chen¹

¹ Taipei Medical University, Taipei, Taiwan, ² Triservice General Hospital of National Defense Medical College, Taipei, Taiwan, ³ Taipei Medical University, Chi-Mei Hospital, Taipei, Taiwan

Room HZ 4

17:00 - 18:30

Parallel scientific session

Inflammatory disease

Chair: T. Ogawa (Japan)

CAN QUANTITATIVE MRI PREDICT CONTRAST ENHANCEMENT IN MULTIPLE SCLEROSIS?

E. Hattingen¹, U. Ziemann², M. Hirschmann¹, M. Wagner¹, C. Schmidt¹, A. Jurcoane¹

¹ Neuroradiology, Goethe University Frankfurt, Frankfurt, Germany, ² Neurology, University Tübingen, Tübingen, Germany

REDUCED DIFFUSION ON MRI IN ACUTE MS LESIONS IS ASSOCIATED WITH CSF PLEOCYTOSIS

P. Eisele, K. Szabo, M. Griebel, M. Wolf, M.G. Hennerici, A. Gass

Dept. of Neurology, University Hospital Mannheim, Mannheim, Germany

MRI FINDINGS IN PATIENTS WITH NEWLY DIAGNOSED NEUROPSYCHIATRIC LUPUS. A SYSTEMATIC APPROACH

N. Sarbu¹, P. Toledano², S. Capurro¹, M.I. Sarbu³, G. Espinosa², R. Cervera², N. Bargalló¹

¹ Hospital Clinic of Barcelona, Department of Radiology, Barcelona, Spain, ² Hospital Clinic of Barcelona, Department of Internal Medicine and Autoimmune Diseases, Barcelona, Spain, ³ Consorci Mar Parc de Salut de Barcelona, Department of Rheumatology, Barcelona, Spain

LOCALIZED SCLERODERMA NEUROLOGICAL MANIFESTATIONS

R. Carvalho¹, F. Sousa², J. Rocha², J. Fernandes¹, J. Rocha¹

¹ Neuroradiology Department, Hospital de Braga, Braga, Portugal, ² Neurology Department, Hospital de Braga, Braga, Portugal

COMBINED USE OF CONVENTIONAL MRI AND SPECTROSCOPY INCREASES DIAGNOSTIC ACCURACY IN AMYOTROPHIC LATERAL SCLEROSIS

A. Cervo¹, S. Coccozza¹, F. Saccà², S.M.D.A. Giorgio¹, V. Brescia Morra², E. Tedeschi¹, A. Marsili², G. Vacca², A. Brunetti¹, M. Quarantelli³

¹ Federico II University, Department of Advanced Biomedical Sciences, Naples, Italy, ² Federico II University, Department of Neurosciences, Reproductive Sciences and Odonto-Stomatology, Naples, Italy, ³ National Research Council, Biostructure and Bioimaging Institute, Naples, Italy

CORRELATION OF EARLY CEREBRAL METABOLIC ALTERATIONS WITH IMMUNOLOGIC DATA AND COGNITIVE TESTS RESULTS IN NEUROLOGICALLY ASYMPTOMATIC HIV-1 POSITIVE AND HCV-POSITIVE PATIENTS

J. Bładowska¹, A. Zimny¹, B. Knysz¹, K. Malyszczak¹, A. Koltowska¹, P. Szewczyk¹,

J. Gasiorowski¹, M. Furdal², M. Sasiadek¹

¹ Wrocław Medical University, Wrocław, Poland, ² Regional Specialistic Hospital, Wrocław, Poland

Monday, September 30, 2013

DIFFUSION-WEIGHTED IMAGING APPEARANCE OF BALO'S CONCENTRIC SCLEROSIS: MULTIPLE STUDIES OF THREE INDIVIDUAL CASES

R. Bert¹, L. Gaido², J. Corboy¹

¹ *University of Colorado Denver, Anschutz Medical Campus, Aurora, CO, USA,* ² *Denver Health, Denver, CO, USA*

EVALUATION OF BRAIN VASCULARITY IN TB MENINGITIS USING MRI/MRA

F. Abu Bakar¹, K. Rahmat¹, N. Ramli¹, S. Tai Mi², C. Tan²

¹ *Department of Biomedical Imaging, University Malaya Medical Centre, Kuala Lumpur, Malaysia,* ² *Department of Medical, University Malaya Medical Centre, Kuala Lumpur, Malaysia*

AGE-RELATED DTI CHANGES IN THE DEEP GRAY NUCLEI

C. Lee¹, K.M. Ng², R. Helmut¹, C.S. Yeoh¹, E.K. Tan^{2,3}, L.L. Chan^{1,2}

¹ *Department of Radiology, Singapore General Hospital, Singapore, Singapore,* ² *Duke-NUS Graduate Medical School, Singapore, Singapore,* ³ *Department of Neurology, National Neuroscience Institute (SGH-Campus), Singapore, Singapore*

Room HZ 5

17:00 - 18:30

Parallel scientific session

Free topics

Chair: J.T. Wilmink (The Netherlands)

MR FINDINGS AND IMAGING TYPES OF FOCAL CORTICAL DYSPLASIA

M. Zhu, D. Zhao, T. Du, L. Wang, X. Zhang, X. Chen

Dept. of Neuroradiology, Beijing Sanbo Brain Hospital, Beijing, China

EXTRA CRANIAL VENOUS ABNORMALITIES IN PATIENTS WITH MULTIPLE SCLEROSIS (MS): A TRUE PATHOLOGICAL FINDING OR AN ANATOMICAL VARIANT?

C. Torres¹, M. Hogan¹, C. Lum¹, S. Chakraborty¹, S. Patro¹, H. Dabirzadeh¹, T. Nguyen¹, M. Bussiere², M. Freedman¹, R. Thornhill¹, L. Kingstone¹, S. Belanger¹, B.A. Schwarz¹

¹ *Ottawa Hospital, University of Ottawa, Ottawa, Canada,* ² *Grey Nuns Community Hospital, Edmonton, Canada*

NSSAFE STUDY: OBSERVATIONAL STUDY ON THE INCIDENCE OF NEPHROGENIC SYSTEMIC FIBROSIS IN RENAL IMPAIRED PATIENTS FOLLOWING GADOTERIC ACID ADMINISTRATION

B. Kress, A. Gottschalk

Institute of Diagnostic and interventional Neuroradiology, Krankenhaus Nordwest, Frankfurt, Germany

A COMBINED LONG TERM MRI AND BEHAVIORAL STUDY ON STATUS-EPILEPTICUS INDUCED NEURODEGENERATION IN RAT: NEUROPROTECTION AND ALLEVIATED EPILEPSY-ASSOCIATED CO-MORBIDITIES BY ADD-ON TREATMENT WITH PHENOBARBITAL

X. Ding¹, J.P. Bankstahl², M. Meier^{3,4}, M. Bankstahl⁵, X. Tang¹, H.J. Hedrich³, W. Löscher⁵, H. Lanfermann¹

¹ *Institute of Diagnostic and Interventional Neuroradiology, Hannover Medical School, Hannover, Germany,* ² *Department of Nuclear Medicine, Hannover Medical School, Hannover, Germany,* ³ *REBIRTH Unit^{8,4}, Hannover Medical School, Hannover, Germany,* ⁴ *Institute of Laboratory Animal Science, Hannover Medical School, Hannover, Germany,* ⁵ *Department of Pharmacology, Toxicology and Pharmacy, University of Veterinary Medicine, Hannover, Germany*

THE RELATIONSHIP BETWEEN HOUNSFIELD UNIT VALUES OBTAINED FROM SKULL BASE CT IMAGES AND DEXA FINDINGS

M. Varer, M. Gursoy, M. Apaydin, E. Uluç, O. Oyar

Department of Radiology, Katip Celebi University Ataturk Education and Training, Izmir, Turkey

Monday, September 30, 2013

EFFICACY AND RELIABILITY ANALYSIS OF 3D-SPACE SEQUENCE IN THE EVALUATION OF PATIENTS WITH HYDROCEPHALUS

G. Kartal ¹, M.S. Ugurel ², O. Algin ¹

¹ Ataturk Training and Research Hospital, Ankara, Turkey, ² Gulhane Military Medical Academy, Ankara, Turkey

NOVEL DEVICE AND PROCEDURE FOR THE TREATMENT OF EPIPHORA

H. Maan ¹, C. Oliver ², B. Willoughby ³, J. Steele ⁴, D. Schomer ¹

¹ Banner MD Anderson Cancer Center, Gilbert, AZ, USA, ² Colorado Head and Neck Specialists, Denver, CO, USA, ³ University of Colorado School of Medicine, Denver, CO, USA, ⁴ MD Anderson Cancer Center, Houston, TX, USA

NOVEL APPLICATION OF A NEW EPIPHORA THERAPY TO TREAT RHINOSINUSITIS

H. Maan ¹, C. Olivier ², B. Willoughby ³, J. Steele ⁴, D. Schomer ¹

¹ Banner MD Anderson Cancer Center, Gilbert, AZ, USA, ² Colorado Head and Neck Specialists, Denver, CO, USA, ³ University of Colorado School of Medicine, Denver, CO, USA, ⁴ MD Anderson Cancer Center, Houston, TX, USA

DRUG-RESISTANT TEMPORAL LOBE EPILEPSY: ROLE OF MAGNETIC RESONANCE IN THE STUDY OF FOCAL CORTICAL DYSPLASIA ASSOCIATED WITH LOW-GRADE TUMOR

F. Toni ¹, A.F. Marliani ¹, F. Bartiromo ¹, A. Tarsi ¹, G. Marucci ², M. Martinoni ³, L. Volpi ⁴, P. Riguzzi ⁴, G. Rubboli ⁴, R. Michelucci ⁴, M. Giulioni ³

¹ IRCCS Istituto delle Scienze Neurologiche di Bologna, Neuroradiology Department, Bellaria Hospital, Bologna, Italy, ² IRCCS Istituto delle Scienze Neurologiche di Bologna, Department of Pathology, Bellaria Hospital, Bologna, Italy, ³ IRCCS Istituto delle Scienze Neurologiche di Bologna, Division of Neurosurgery, Bellaria Hospital, Bologna, Italy, ⁴ IRCCS Istituto delle Scienze Neurologiche di Bologna, Division of Neurology, Bellaria Hospital, Bologna, Italy

Room HZ 15

17:00 - 18:30

Parallel scientific session

Advanced imaging: epilepsy and consciousness

Chair: P. Barsi (Hungary)

FUNCTIONAL MRI OF PATIENTS WITH DISORDERS OF CONSCIOUSNESS

L. Hermoye ¹, L. Tshibanda ², W. Gradkowski ¹, V. Katsaros ³, A. Vanhauudenhuysse ², S. Laureys ²

¹ Imagily, Brussels, Belgium, ² Liege University, Coma Science Group, Liege, Belgium, ³ Athens University, Athens, Greece

CHANGES OF GABA AND GLUTAMINE IN JUVENILE MYOCLONIC EPILEPSY MEASURED BY MR SPECTROSCOPY

C. Lueckerath ¹, U. Pilatus ¹, S. Knake ², M. Kieslich ³, E. Hattingen ¹

¹ Neuroradiology, Goethe University Frankfurt, Frankfurt, Germany, ² Centrum of Epilepsy Hessen, Marburg, Germany, ³ Pediatric Neurology, Goethe University Frankfurt, Frankfurt, Germany

LIMBIC DYSCONNECTIVITY IN DISORDERS OF CONSCIOUSNESS

C. Di Perri ¹, S. Bastianello ², A. Bartsch ³, C. Pistarini ⁴, G. Maggioni ⁴, L. Magrassi ⁵,

R. Imberti ⁵, A. Pichiecchio ², S. Laureys ¹, F. Di Salle ⁶

¹ Coma Science Group, Liege, Belgium, ² Mondino, Pavia, Italy, ³ University of Heidelberg, Heidelberg, Germany, ⁴ Maugeri, Pavia, Italy, ⁵ S Matteo, Pavia, Italy, ⁶ University of Salerno, Salerno, Italy

Monday, September 30, 2013

OPTIC PATHWAY INVOLVEMENT IN ALSTROM SYNDROME: A MRI MULTIMODALITY STUDY

V. Citton¹, A. Favaro², J. Marshall³, V. Bettini⁴, N.A. Greggio⁵, F. Favaretto⁴, G. Milan⁴, K. Naggert³, P. Meneguzzo², G. Zorzi², A. Salvalaggio², C. Idotta², L. Weis¹, P. Maffei⁴, R. Manara^{1,6}

¹ *Neuroradiology Unit, IRCCS San Camillo Hospital, Venice, Italy,* ² *Department of Neurosciences, University of Padua, Padua, Italy,* ³ *The Jackson Laboratory, Bar Harbor, ME, USA,* ⁴ *Internal Medicine³, Dept. of Medicine, University Hospital of Padua, Padua, Italy,* ⁵ *Pediatric Endocrinology Unit, Dept. of Pediatrics, University Hospital of Padua, Padua, Italy,* ⁶ *Neuroradiology Unit, University of Salerno, Salerno, Italy*

RESTING-STATE FMRI IN AN INTRAOPERATIVE MR-SETTING:

FEASIBILITY AND PRELIMINARY RESULTS

S. Bisdas¹, C. Roder², E. Charyasz¹, U. Klose¹, M.S. Tatagiba², U. Ernemann¹

¹ *Eberhard Karls University, Neuroradiology, Tübingen, Germany,* ² *Eberhard Karls University, Neurosurgery, Tübingen, Germany*

ASSESSMENT OF THIRD VENTRICULOSTOMY PATENCY WITH 3D-SPACE TECHNIQUE: A MULTICENTER RESEARCH STUDY

O. Algin¹, M. Ucar², M.G. Kartal¹, A. Börcek², P.A. Ozisik³, E. Ozmen¹, T. Tali²

¹ *Ataturk Training and Research Hospital, Ankara, Turkey,* ² *Gazi University, Medical Faculty, Ankara, Turkey,* ³ *Koru Hospital, Ankara, Turkey*

ROLE OF COMBINED STRUCTURAL MR IMAGING AND SPECT CT IN THE MANAGEMENT OF REFRACTORY EPILEPSY

K. Rahmat, H. Taha, N. Ramli, F. Fadzli, K.S. Lim

University of Malaya, Kuala Lumpur, Malaysia

CAPABILITIES OF MRI IN ASSESSMENT OF RESULTS OF FOCAL CRYOABLATION OF THE MAMMALIAN BRAIN (EXPERIMENTAL WORK)

S. Osipov, V.V. Khovrin, T.N. Galyan, S.A. Vasiliev, S.B. Pesnya-Prosolov

Petrovsky National Research Center of Surgery, Moscow, Russia

SCIENTIFIC PROGRAM

Tuesday, October 1, 2013

37th ESNR Annual Meeting

Room HZ 2

08:00 - 09:00 **REFRESHER COURSE DIAGNOSTIC • Epilepsy, head and neck**

Chair: E.T. Tali (Turkey)

Tumors in epilepsy

A. Osborn (USA)

Cranial nerve palsies in head and neck diseases

M. Mack (Germany)

Room HZ 3

08:00 - 09:00 **REFRESHER COURSE INTERVENTIONAL • Advanced angiographic imaging and radiation protection**

Chair: J. Berkefeld (Germany)

Beyond fluoroscopy and DSA: indications for new neuroangiographic features

A. Dörfler (Germany)

Radiation dose in interventional neuroradiology

M. Söderman (Sweden)

Radiation protection in interventional neuroradiology

R. Anxionnat (France)

Room HZ 2

09:00 - 10:00 **Paediatric**

Chair: C. Hoffman (Israel)

Diagnostic Pediatrics: epilepsy in malformations of the cerebral cortex

N. Colombo (Italy)

Uncommon pediatric tumors

M. Warmuth-Metz (Germany)

Room HZ 3

09:00 - 10:00 **Imaging in Psychiatry**

Chair: G. Wilms (Belgium)

The role of neuroradiology in clinical psychiatry

J. Pantel (Germany)

MICROARCHITECTURE OF HIPPOCAMPUS: HOW MUCH CAN BE RESOLVED ON CLINICAL 3T MRI?

V. Gupta, P. Vibhute

Mayo Clinic, Radiology, Jacksonville, FL, USA

NO DIFFERENCE OF GREY MATTER DISTRIBUTION COMPARED TO CONTROLS BUT REGIONALLY ACCENTUATED REVERSIBLE BRAIN GREY MATTER REDUCTION IN ULTRA MARATHON RUNNERS DETECTED BY VOXEL BASED MORPHOMETRY

W. Freund¹, S. Faust¹, F. Birklein², C. Billich¹, A. Wunderlich¹, U. Schuetz¹

¹ *Diagnostic and Interventional Radiology, University Hospitals Ulm, Ulm, Germany,* ² *Neurology, University Medical Centre Mainz, Mainz, Germany*

10:00 - 10:30 *Coffee Break*

SCIENTIFIC PROGRAM

Tuesday, October 1, 2013

Room HZ 2

10:30 - 12:00

ESNR - ASNR joint session

Chair: E.T. Tali (Turkey)

Advanced imaging of brain tumors with a focus on molecular characterization

R. Colen (USA)

MEG and MRI of the cognitive consequences of traumatic brain injury

R. Lee (USA)

Advanced imaging of stroke

G. Zaharchuk (USA)

Room HZ 3

10:30 - 12:00

Parallel scientific session

Advanced imaging: future techniques in neuroradiology

Chair: R. Siemund (Sweden)

EVALUATION OF THE PONTINE PERFORATORS OF THE BASILAR ARTERY USING DIGITAL SUBTRACTION ANGIOGRAPHY IN HIGH RESOLUTION AND 3D-ROTATION TECHNIQUE

S. Lescher, T. Samaan, J. Berkefeld

Institute of Neuroradiology, Frankfurt Am Main, Germany

A COMPARATIVE PHANTOM STUDY ON RADIATION EFFECTIVE DOSES OF CEREBRAL HEMODYNAMICS MEASUREMENT BETWEEN DYNA CT AND MULTIDETECTOR CT

W. Guo¹, C. Lin^{1,2}, W. Chen³, S. Hung^{1,2}, W. Chu¹, C. Chiu¹, T. Wu³

¹ Taipei Veterans General Hospital, Taipei, Taiwan, ² School of Medicine, National Yang-Ming University, Taipei, Taiwan, ³ Department of Biomedical Imaging and Radiological Sciences, National Yang-Ming University, Taipei, Taiwan

NEUROSURGICAL ICU: ULTRA-LOW DOSE SAFIRE BASED HEAD CT SATISFACTORY FOR REPEATED SURVEILLANCE EXAMS

I. Corcuera-Solano, A. Noor, A. Doshi, L. Tanenbaum

Icahn School of Medicine at Mount Sinai, New York, NY, USA

CORONAL OBLIQUE ORIENTATION OFFERS IMPROVED VISUALIZATION OF NEUROFORAMINA IN CERVICAL SPINE MAGNETIC RESONANCE IMAGING

W. Freund¹, S. Klessinger², M. Mueller¹, M. Halatsch³, G. Hoepner¹, B. Schmitz⁴

¹ Diagnostic and Interventional Radiology, University Hospitals Ulm, Ulm, Germany, ² Neurosurgery, Nova Clinic, Biberach, Germany, ³ Neurosurgery, University Hospitals Ulm, Ulm, Germany, ⁴ Neuroradiology, University Hospitals Ulm, Ulm, Germany

QUANTITATIVE CEREBRAL ANGIOGRAPHY TO EVALUATE HYPERPERFUSION POSTCAROTID STENTING

E. Tsai¹, B.C.J. Lin², F.C. Chang², W.Y. Guo^{1,2}, D.Y.T. Chen¹

¹ Taipei Medical University, Imaging Research Center, Taipei, Taiwan, ² Taipei Veterans General Hospital, Radiology Department, Taipei, Taiwan

DIFFERENTIAL DIAGNOSIS OF BRAIN LESIONS USING MRI, PROTON MR SPECTROSCOPY (MRS) AND INTERPRET DECISION SUPPORT SYSTEM (DSS). A COMPARATIVE STUDY

R. Romanos-Zapata, F. Ortiz-Nieto, R. Raininko

Uppsala University, Department of Radiology, Uppsala, Sweden

Tuesday, October 1, 2013

BRAIN CHANGES IN KALLMANN SYNDROME

A. Salvalaggio¹, R. Manara^{2,3}, A. Favaro¹, V. Palumbo⁴, C. Idotta¹, V. Citton³,
A. D'Errico⁵, A. Elefante⁵, G. Ottaviano⁶, E. Cantone⁵, C. Briani¹, N.A. Greggio⁷, L. Weis³,
S. Rizzati⁸, E. Napoli⁹, G. Coppola¹⁰, A. Brunetti⁵, F. Di Salle², G. Bonanni⁸, A.A. Sinisi⁴
¹ Dept. of Neurosciences, University of Padova, Padova, Italy, ² Neuroradiology, University of Salerno, Salerno, Italy, ³ IRCCS San Camillo, Venezia, Venezia, Italy, ⁴ Endocrinology and Medical Andrology, Second University of Napoli, Napoli, Italy, ⁵ Federico II University, Napoli, Napoli, Italy, ⁶ Otolaryngology Section, Dept of Neurosciences, University of Padova, Padova, Italy, ⁷ UOS di Endocrinologia Pediatrica, Azienda Ospedaliera, Padova, Italy, ⁸ Dept. of Medicine (DIMED), University of Padova, Padova, Italy, ⁹ Medicanova, Diagnostic Center, Battipaglia, Salerno, Italy, ¹⁰ Child and Adolescent Neuropsychiatry, University of Salerno, Salerno, Italy

VISUALIZING PLASTICITY AND ALTERED NEURONAL SIGNALING IN THE INJURED HUMAN SPINAL CORD WITH FMRI

D. Cadotte¹, D. Mikulis², R. Bosma³, P. Stroman³, M. Fehlings¹
¹ University of Toronto, Dept. of Surgery, Division of Neurosurgery, Toronto, Canada, ² University of Toronto, Department of Radiology, Division of Neuroradiology, Toronto, Canada, ³ Queens University, Kingston, Canada

12:00 - 13:00 **Closing Ceremony**

BRAIN TUMORS, DIAGNOSTIC AND INTERVENTIONAL

001 • SELECTIVE EMBOLIZATION OF NECK OF INTRACRANIAL ANEURYSMS WITH PLATINUM COILS

M. Wu¹, C. Shen¹, Y. Tyan¹, H. Wong²

¹ Department of Medical Imaging, Chung Shan Medical University Hospital and Institute of Medicine, CSMU, Taichung, Taiwan, ² Department of Neuroradiology, Chang Gung Memorial Hospital and Chang Gung University, Taoyuan, Taiwan

002 • IMAGING REVIEW OF DYSEMBRYOPLASTIC NEUROEPITHELIAL TUMOR (DNET)

L. Wang¹, B. Jones², K. Dorris²

¹ University Hospital, Cincinnati, OH, USA, ² Cincinnati Children's Hospital Medical Center, Cincinnati, OH, USA

003 • PROGNOSTIC VALUE OF MRI DSC-T2* CEREBRAL PERFUSION IN GBM (GLIOBLASTOMA MULTIFORME) PATIENTS

J. Villanua¹, E. Fernandez¹, J. Larrea², E. Pardo², P. Aldaz³, C. Barrena⁴, E. Carrasco³, E. Sarasqueta⁵, I. Ruiz⁶, A. Matheu³

¹ Unidad Donostia, Osatek Sa. Donostia University Hospital, Donostia-SS, Spain, ² Radiology Department, Donostia University Hospital, Donostia-SS, Spain, ³ Neurooncology Group, Biodonostia Institute, Donostia University Hospital, Donostia-SS, Spain, ⁴ Neurosurgery Department, Donostia University Hospital, Donostia-SS, Spain, ⁵ Epidemiology Department, Donostia University Hospital, Donostia-SS, Spain, ⁶ Pathology Department, Donostia University Hospital, Donostia-SS, Spain

004 • ANEURYSMAL BONE CYST OF SPHENOID BONE AND CLIVUS MISDIAGNOSED AS CHORDOMA: A CASE REPORT

F. Ustabasioglu, I. Yanik, E. Huseynov, M. Asik, Z.I. Hasiloglu

Istanbul University Cerrahpasa Medical Faculty-Department of Radiology, Istanbul, Turkey

005 • DIFFERENTIATION OF PRIMARY AND SECONDARY BRAIN TUMOURS USING DYNAMIC SUSCEPTIBILITY CONTRAST MRI PERFUSION

A. Sprlakova-Pukova¹, M. Kerkovsky¹, J. Stulik¹, R. Jirik², O. Macicek², K. Bartusek²

¹ The University Hospital Brno and Masaryk University, Department of Radiology, Brno, Czech Republic, ² Brno University of Technology, Department of Biomedical Engineering, Brno, Czech Republic

006 • IDENTIFICATION OF TREATMENT VOLUMES FOR RADIOTHERAPY PLANNING OF THE INTRA-AXIAL BRAIN TUMORS USING CT AND MR IMAGES FUSION

L. Sibilla¹, G.B. Ivaldi², S. Montagna¹, P. Tabarelli³, M. Liotta³, L. Moro³, M. Baldi¹

¹ Research Institute S. Maugeri Found, Radiology Dpt., Pavia, Italy, ² Research Institute S. Maugeri Found, Radiotherapy Dpt., Pavia, Italy, ³ Research Institute S. Maugeri Found, Medical Physics Service, Pavia, Italy

007 • ORBITAL CAVERNOUS HEMANGIOMA: DIAGNOSIS WITH CT-PERFUSION

I. Schurova, I. Pronin, V. Kornienko

Burdenko Neurosurgery Institute, Moscow, Russia

008 • 3D-TSE-T1W:A MATTER OF SENSITIVITY

I. Saralegui¹, I. Vicente¹, J.M. Ontañón¹, J. Sanchez², A. Cabrera¹

¹ Galdakao Hospital, OSATEK, Usansolo, Spain, ² MR Clinical Department, Philips Healthcare Iberia, Madrid, Spain

009 • MRI BLOOD POOL CONTRAST AGENTS: IMPROVED IMAGING OF GLIOBLASTOMA

J. Puig¹, G. Blasco¹, W. Chwang², J. Daunis-I-Estadella³, M. Essig⁴, R. Jain², S. Pedraza¹

¹ Department of Radiology (IDI), Girona Biomedical Research Institute (IDIBGI), Hospital Universitari Dr Josep Trueta, Girona, Spain, ² Division of Neuroradiology, Department of Radiology, Henry Ford Health System, Detroit, MI, USA, ³ Department of Computer Science, Applied Mathematics and Statistics, University of Girona, Girona, Spain, ⁴ Diagnostic Radiology and Neuroradiology, Department of Neuroradiology, University of Erlangen, Erlangen, Germany

010 • VALUE OF DIFFUSION TENSOR IMAGING IN DIFFERENTIATING HIGH-GRADE FROM LOW-GRADE GLIOMAS

S. Piyapittayanon¹, O. Chawalparit¹, S. Tritakarn¹, T. Witthiwej², T. Sangruchi³, S. Nanta-Aree², S. Sathornsumete⁴, P. Itthimethin², C. Komoltri⁵

¹ Siriraj Hospital, Department of Radiology, Bangkok, Thailand, ² Siriraj Hospital, Department of Surgery, Bangkok, Thailand, ³ Siriraj Hospital, Department of Pathology, Bangkok, Thailand, ⁴ Siriraj Hospital, Department of Medicine, Bangkok, Thailand, ⁵ Siriraj Hospital, Department of Research Development, Bangkok, Thailand

011 • METASTATIC MELANOMA FOR DUMMIES

J. Nair¹, C.I. Torres¹, J. Chankowsky¹, R. Del Carpio-O'Donovan¹, J. Beegom Mansoor²

¹ Department of Radiology, Montreal General Hospital, McGill University, Montreal, Montreal, Canada, ² Baraha Hospital, Ministry of Health, Dubai, United Arab Emirates

012 • FUNCTIONAL NEUROIMAGING TECHNIQUES IN THE EVALUATION OF CENTRAL NERVOUS SYSTEM TUMORS: A MULTIMODALITY AND COMPREHENSIVE APPROACH

J. Martínez Barbero¹, T. Martín Noguerol¹, M. Navarro-Pelayo Láinez², M. Gómez Río², J. Pastor Rull³

¹ Clínica Las Nieves, Neuroimaging Department, Grupo Health-Time, Jaén, Spain, ² Hospital Universitario Virgen de las Nieves, Servicio de Medicina Nuclear, Granada, Spain, ³ Hospital Universitario Virgen de las Nieves, Servicio de Radiología, Sección de Neuroimagen, Granada, Spain

014 • INTRACRANIAL HEMANGIOPERICYTOMA: CASE REPORT AND REVIEW OF LITERATURE

C. Gagliardo, S. Regalbuto, C. Sarno, F. Cannizzaro, G. La Tona, M. Midiri

DI.BI.MEF, Radiology Section, University of Palermo, Palermo, Italy

015 • DIAGNOSTIC PERFORMANCE OF ADVANCED MRI IN DIFFERENTIATING HIGH-GRADE FROM LOW-GRADE GLIOMAS IN A SETTING OF ROUTINE SERVICE

O. Chawalparit¹, T. Sangruchi², T. Witthiwej³, S. Sathornsumetee⁴, S. Tritrakarn¹, S. Piyapittayanan¹, P. Chaicharoen¹, T. Direksunthorn¹, P. Charnchaowanish¹

¹ Department of Radiology, Faculty of Medicine Siriraj Hospital, Mahidol University, Bangkok, Thailand, ² Department of Pathology, Faculty of Medicine Siriraj Hospital, Mahidol University, Bangkok, Thailand,

³ Department of Surgery, Faculty of Medicine Siriraj Hospital, Mahidol University, Bangkok, Thailand,

⁴ Department of Medicine, Faculty of Medicine Siriraj Hospital, Mahidol University, Bangkok, Thailand

016 • AMIDE PROTON TRANSFER IMAGING: IS SINGLE REPRESENTATIVE SLICE ANALYSIS SUFFICIENT FOR TUMOR GRADING?

S. Akihiko¹, T. Okada¹, A. Yamamoto¹, M. Kanagaki¹, Y. Fushimi¹, E. Morimoto¹, R. Sakamoto¹, T.H. Mehemed¹, S. Nakajima¹, S. Okuchi¹, T. Kakigi¹, T. Dodo¹, B. Schmitt², K. Murata³, K. Togashi¹

¹ Department of Diagnostic Imaging and Nuclear Medicine, Kyoto University, Kyoto, Japan, ² Siemens AG, Munich, Germany, ³ Siemens Japan, Tokyo, Japan

017 • A CASE REPORT OF GLIOSARCOMA: CT AND MRI FINDINGS

K. Suzuki¹, M. Hori², H. Suzuki¹, M. Kobayashi¹, J. Kodera¹, Y. Okada¹, S. Mizumura¹, N. Shiraga¹, H. Terada³, T. Nagao³, T. Kuroki³, W. Tokuyama³, H. Hiruta³, E. Kohta⁴

¹ Toho University Omori Medical Center, Tokyo, Japan, ² Juntendou University, Tokyo, Japan, ³ Toho University Sakura Medical Center, Chiba, Japan, ⁴ Toho University School of Medicine, Tokyo, Japan

HEAD AND NECK IMAGING

018 • ADULT PAROTID TUMORS: A RADIOPATHOLOGIC CORRELATION

D.T. Wang¹, L.L. Wang², A. Bahel², I. Bhutani³, R. Cornelius²

¹ Department of Radiology, Royal Melbourne Hospital, Melbourne, Australia, ² University of Cincinnati, Hospital Medical Center, Cincinnati, OH, USA, ³ Department of Pathology, University of Cincinnati Medical Center, Cincinnati, OH, USA

019 • ALGORITHMIC APPROACH TO CYSTIC LESIONS OF THE PAROTID GLAND AND THEIR MIMICS

E. Ryan, M. Mccusker, M. Thornton, A. O'Hare, P. Brennan, S. Looby

Department of Neuroradiology, Beaumont Hospital, Dublin, Ireland

020 • THE VERTEBRAL ARTERY - ORIGIN, EXTRACRANIAL COURSE, VARIATIONS AND ASSOCIATION WITH VASCULAR DISEASES DIAGNOSED BY CTA

M. Tysiac¹, F. Brassel², A. Berenstein³, D. Meila^(2,4)

¹ Klinikum Duisburg, Sana Kliniken, Department of Anaesthesiology, Duisburg, Germany, ² Klinikum Duisburg, Sana Kliniken, Department of Radiology and Neuroradiology, Duisburg, Germany, ³ Roosevelt Hospital, Center for Endovascular Surgery, New York, NY, USA, ⁴ Hannover Medical School, Department of Diagnostic and Interventional Neuroradiology, Hannover, Germany

021 • ANATOMICAL AND PATHOLOGICAL MRI ATLAS OF UPPER THORACIC OUTLET. A NEW APPROACH TO AN OLD CHALLENGE

J. Martínez Barbero, T. Martín Noguero

Clinica Las Nieves, Sercosa, Grupo Health-Time, Jaen, Spain

022 • THE VALUE OF MR IMAGING FOR THE DIAGNOSIS OF OPTIC NERVE NEUROPATHY IN PATIENTS WITH GRAVES' DISEASE

E. Maj¹, A. Cieszanowski¹, P. Miskiewicz², K. Trautsolt², T. Bednarczuk², A. Samsel³, A. Krzeski⁴, O. Rowinski¹

¹ Medical University of Warsaw, ^{2nd} Department of Clinical Radiology, Warsaw, Poland, ² Medical University of Warsaw, Chair and Department of Internal Medicine and Endocrinology, Warsaw, Poland, ³ Medical University of Warsaw, Chair and Department of Ophthalmology, Warsaw, Poland, ⁴ Medical University of Warsaw, Department of Otolaryngology, Warsaw, Poland

023 • HYPERINTENSITY IN THE SUBARACHNOID SPACE ON FLAIR MRI IN PATIENTS WITH RENAL INSUFFICIENCY: A DIAGNOSTIC PITFALL

H. Kalkan, D. Kiresi

Necmettin Erbakan University, Meram School of Medicine, Department of Radiology, Konya, Turkey

024 • BRAIN MRI AND CT UTILIZATION TRENDS AMONG MEDICARE BENEFICIARIES: 2000-2007

R. Dhangana, P. Dhangana, M. Gupta, G. Muro

Bridgeport Hospital, Yale New Haven Health, Department of Diagnostic Imaging, Bridgeport, CT, USA

025 • TRANSPHENOIDAL MENINGOENCEPHALOCELE WITH NASAL FOSSA EXTENSION

V. Cruz E Silva, J. Barreira, J. Graça, J. Ruivo, P. Soares

Neuroradiology Department, Hospital Egas Moniz, CHLO, Lisbon, Portugal

026 • SPONTANEOUS PNEUMOLABYRINTH AFTER VALSALVA MANEUVER SECONDARY TO PERILYMPHATIC FISTULA

R. Carvalho¹, J. Guimaraes², J. Fernandes¹, S. Vilarinho², J. Rocha¹

¹ Neuroradiology Department, Hospital de Braga, Braga, Portugal, ² Otorinolaringology Department, Hospital de Braga, Braga, Portugal

027 • IDENTIFICATION OF PARANASAL SINUSES ANATOMICAL VARIANTS BY COMPUTED TOMOGRAPHY

R. Carvalho¹, R. Figueroa²

¹ Hospital de Braga, Braga, Portugal, ² Georgia Health Sciences University Medical College of Georgia, Augusta, GA, USA

028 • NEUROIMAGING FINDINGS IN RENAL FAILURE AND RENAL DISEASE

R. Brennan, A. O'Hare, J. Thornton, P. Brennan, S. Looby

Beaumont Hospital, Department of Academic Radiology, Dublin, Ireland

029 • IMAGING OF FOREIGN BODIES IN THE HEAD, NECK AND ORBIT

D. Mcweeney, J. O'Dowd, L. Galvin, R. Grech, A. O'Hare, J. Thornton, P. Brennan, S. Looby

Diagnostic and Interventional Neuroradiology, Beaumont Hospital, Dublin, Ireland

030 • NEOPLASTIC AND NON-NEOPLASTIC LESIONS AFFECTING THE SKULL BASE - WHAT DO WE NEED TO KNOW? CLINICAL CASES IN A PICTORIAL ESSAY

M. Sarpi, E. Gebrim, M. Garcia, F. Cevasco, M. Daniel, R. Elia, U. Passos, H. Zuppani

INRAD - FMUSP, São Paulo, Brazil

031 • DCE-MRI IN HEAD AND NECK LESIONS: PICTORIAL REVIEW

J. Ontañón, I. Vicente, I. Saralegui, A. Cabrera

OSATEK MRI Unit, Galdakao, Spain

INFLAMMATORY, DEMYELINATING AND DEGENERATIVE DISEASES OF THE BRAIN

033 • SIGNIFICANCE OF COMBINED USE OF MR IMAGING AND PERFUSION SPECT FOR THE EVALUATION OF MULTIPLE SYSTEM ATROPHY

T. Ogawa, Y. Kanasaki, S. Fujii, Y. Shinohara, T. Kaminou, F. Miyoshi

Tottori University, Yonago, Japan

034 • CEREBRAL AMYLOID ANGIOPATHY-RELATED INFLAMMATION: FROM CLINICAL PRESENTATION TO NEURORADIOLOGICAL DIAGNOSIS

M. Martucci¹, S. Sarria¹, C. Vert¹, M. Toledo², P. Coscojuela¹, S. Siurana¹, C. Auger¹, A. Rovira¹
¹Neuroradiology Unit, Radiology Department, Vall d'Hebrón University Hospital, Barcelona, Spain, ²Epilepsy Unit, Neurology Department, Vall d'Hebrón University Hospital, Barcelona, Spain

035 • SUPRATENTORIAL MICROSTRUCTURAL WHITE MATTER ABNORMALITIES IN FRIEDREICH ATAXIA - A DTI STUDY

T. Lindig¹, B. Bender¹, T. Nägele¹, U. Klose¹, M. Synofzik², L. Schöls², S. Mang³
¹Radiologische Universitätsklinik, Abteilung Diagnostische und Interventionelle Neuroradiologie, Tübingen, Germany, ²Neurologische Klinik und Hertie-Institut für klinische Hirnforschung, Abteilung Neurodegeneration, Tübingen, Germany, ³Deutsches Krebsforschungszentrum Heidelberg, Softwareentwicklung für Integrierte Diagnostik und Therapie, Heidelberg, Germany

036 • SUSCEPTIBILITY-WEIGHTED IMAGING IN THE DIFFERENTIATION OF PYOGENIC BRAIN ABSCESSSES FROM NECROTIC GLIOBLASTOMAS

P. Lai¹, T.C. Chuang², H.C. Chang³, H.W. Chung⁴, H.S. Lin⁵, J.H. Fu¹, P.C. Wang¹, H.B. Pan¹
¹Department of Radiology, Kaohsiung Veterans General Hospital, Kaohsiung, Taiwan, ²Department of Electrical Engineering, National Sun Yat-Sen University, Kaohsiung, Taiwan, ³Brain Imaging and Analysis Center in the School of Medicine at Duke University, Durham, NC, USA, ⁴Department of Electrical Engineering, National Taiwan University, Taipei, Taiwan, ⁵Program of Health-Business Administration, School of Nursing, Fooyin University, Kaohsiung, Taiwan

037 • MR PRESENTATION OF CREUTZFELDT-JAKOB DISEASE-CASE REPORT OF SPORADIC FORM

B. Georgievski-Brkic¹, M. Radovic-Stefanovic², A. Terzic-Beljakovic¹, B. Vukomancic¹, M. Pesovic-Grbovic¹, T. Jaramaz-Ducic³, M. Vukicevic³
¹Stroke Hospital Sveti Sava, Radiology Department, Belgrade, Serbia, ²Clinical Centar Bezanjska kosa, Radiology Department, Belgrade, Serbia, ³Stroke Hospital Sveti Sava, Neurology Department, Belgrade, Serbia

038 • FRACTIONAL ANISOTROPY IN THE CENTRUM SEMIOVALE AS A QUANTITATIVE INDICATOR OF CEREBRAL WHITE MATTER DAMAGE IN THE SUBACUTE PHASE IN PATIENTS WITH CARBON MONOXIDE POISONING: CORRELATION WITH CONCENTRATION OF MYELIN BASIC PROTEIN IN CEREBROSPINAL FLUID

T. Beppu, S. Fujiwara, K. Ogasawara, M. Sasaki
Iwate Medical University, Morioka, Japan

039 • THE EFFECT OF DISEASE DURATION ON MR RESTING STATE DATA OF MS PATIENTS

B. Bender¹, E. Charyasz¹, L. Zeltner², P. Rebasso^{2,3}, H.O. Karnath^{2,3}, F. Bischof², U. Klose¹
¹MR Research Group, Dept. of Diagnostic and Interventional Neuroradiology, University Tübingen, Tübingen, Germany, ²Department of Neurology, University Tübingen, Tübingen, Germany, ³Division of Neuropsychology, Hertie-Institute for Clinical Brain Research, Tübingen, Germany

040 • INVESTIGATING THE ROLE OF BRAIN JUXTACORTICAL LESIONS IN CORTICAL THICKNESS MEASUREMENTS

C. Auger¹, D. Pareto¹, J. Sastre-Garriga², Y. Vives-Gilabert³, J. Delgado³, E. Hueriga¹, M. Tintore², X. Montalban², A. Rovira¹
¹MRI Unit Radiology Department, Vall D'Hebron Hospital, Barcelona, Spain, ²Neurology Department, CEMCAT, Vall D'Hebron Hospital, Barcelona, Spain, ³PIC-IFAE, Universitat Autònoma Barcelona, Barcelona, Spain

041 • EVALUATION VALUE OF MAGNETIZATION TRANSFER MARKERS AS EARLY PREDICTORS OF CLINICAL DISABILITY AND LESION LOAD PROGRESSION IN CLINICALLY ISOLATED SYNDROME

A. Royo¹, C. Utrilla¹, S. Noval², P.S. Garcia-Raya¹, J. Alvarez-Linera³, C. Valencia⁴, G. Garzon⁵, C. Oreja-Guevara⁴
¹Neuroradiology, University Hospital La Paz, Madrid, Spain, ²Ophthalmology, University Hospital La Paz, Madrid, Spain, ³Neuroradiology, Hospital Ruber Internacional, Madrid, Spain, ⁴Neurology, University Hospital Clínico, Madrid, Spain, ⁵Radiology, University Hospital La Paz, Madrid, Spain

042 • EVOLUTION OF GADOLINIUM-ENHANCING LESIONS IN CLINICALLY ISOLATED SYNDROME AND RELAPSING-RECURRENT MULTIPLE SCLEROSIS

A. Royo¹, C. Utrilla¹, S. Noval², R. Frutos¹, C. Valencia³, G. Garzon⁴, J. Alvarez-Linera⁵, C. Oreja-Guevara³
¹ Neuroradiology, University Hospital La Paz, Madrid, Spain, ² Ophthalmology, University Hospital La Paz, Madrid, Spain, ³ Neurology, University Hospital Clinico, Madrid, Spain, ⁴ Radiology, University Hospital La Paz, Madrid, Spain, ⁵ Neuroradiology, Hospital Ruber Internacional, Madrid, Spain

PEDIATRIC NEURORADIOLOGY

043 • FETAL MRI: EMBRYOLOGY, ANATOMY AND PATHOLOGY OF POSTERIOR FOSSA

M. Recio¹, P. Martínez Ten², B. Adiego³, J. Pérez Pedregosa⁴, A. Álvarez¹, C. Hayoun¹
¹ Hospital Universitario Quiron Madrid, Pozuelo De Alarcon, Spain, ² Delta Ecografía, Madrid, Spain, ³ Hospital Universitario Fundacion Alcorcon, Madrid, Spain, ⁴ Hospital La Moraleja, Madrid, Spain

044 • MOYAMOYA DISEASE IN CHILDREN - SPECTRUM OF MAGNETIC RESONANCE BRAIN CHANGES

K. Nowak, E. Jurkiewicz, P. Daszkiewicz, D. Kuczynski, K. Malczyk
IP-CZD, Warsaw, Poland

045 • MAGNETIC RESONANCE IMAGING OF THE SPINAL CORD IN CHILDREN AND ADOLESCENTS WITH MULTIPLE SCLEROSIS

E. Jurkiewicz¹, K. Nowak¹, K. Kotulska², K. Malczyk¹, D. Chmielewski², M. Bilska²
¹ The Children's Memorial Health Institute, Department of Diagnostic Imaging, Warsaw, Poland,
² The Children's Memorial Health Institute, Department of Neurology, Warsaw, Poland

046 • CASE PRESENTATION OF DIASTEMATOMYELIA. HOW IMPORTANT TO MAKE PRENATAL DIAGNOSIS OF NEURAL TUBE ANOMALY?

A. Jasovic, S. Dowlut, T. Ghoorah
Apollo Bramwell Hospital, Moka, Mauritius

047 • SPECTRUM OF NEURORADIOLOGICAL FINDINGS IN CHARGE SYNDROME: A PICTORIAL REVIEW

T. Demerath¹, M. Krüger², S. Meckel¹
¹ University Hospital Freiburg, Department of Neuroradiology, Freiburg, Germany, ² University Hospital Freiburg, Department of Child and Youth Health, Freiburg, Germany

048 • LEIGH DISEASE

A. Bocchio¹, G. Voltolin², D. Machado¹, T. Meloni¹
¹ General Hospital U. Parini, Department of Radiology, Aosta, Italy, ² Beauregard Hospital, Department of Neuropsychiatry, Aosta, Italy

049 • ADVANCED MR IMAGING TECHNIQUES TO REFINE THE CONCEPTUAL APPROACH IN PEDIATRIC WHITE MATTER DISEASES

A. Allmendinger¹, A. Burke², N. Viswanadhan¹, S. Prabhu¹
¹ Boston Children's Hospital, Harvard Medical School, Boston, MA, USA, ² Franciscan Children's Hospital, Boston, MA, USA

050 • CONGENITAL SPINAL MALFORMATIONS DEMYSTIFIED

A. Allmendinger¹, A. Burke², N. Viswanadhan¹, S. Prabhu¹
¹ Boston Children's Hospital, Boston, MA, USA, ² Franciscan Children's Hospital, Boston, MA, USA

051 • THE ROLE OF ADVANCED TECHNIQUES IN MR NEUROIMAGING IN SURGICAL MANAGEMENT OF BRAINSTEM-EXPANDING LESIONS IN CHILDHOOD

C. Utrilla¹, A. Royo¹, F. Carceller², A. Alvarez-Muelas¹, P.S. Garcia-Raya¹, A.F. Fernandez-Prieto¹, G. Garzon³
¹ Neuroradiology, University Hospital La Paz, Madrid, Spain, ² Pediatric Neurosurgery, University Hospital La Paz, Madrid, Spain, ³ Radiology, University Hospital La Paz, Madrid, Spain

SPINE, DIAGNOSTIC IMAGING

052 • THE ROLE OF MR TRACTOGRAPHY OF MEDULLA AND CERVICAL SPINE IN TREATMENT OF TUMORS AND TUMOR-LIKE LESIONS

E. Maj¹, A. Cieszanowski¹, M. Prokopenko², P. Kunert², A. Marchel², O. Rowinski¹
¹ Medical University of Warsaw, 2nd Department of Clinical Radiology, Warsaw, Poland, ² Medical University of Warsaw, Chair and Department of Neurosurgery, Warsaw, Poland

053 • CERVICAL SPINAL CORD COMPRESSION: PREVALENCE AND DIFFUSION TENSOR IMAGING DATA ANALYSIS

M. Kerkovsky¹, J. Bednarik^{2,3}, B. Jakubcova¹, Z. Kadanka², Z. Kadanka Jr.², M. Nemeč², I. Kovalova², A. Sprlakova-Pukova¹

¹ Department of Radiology, The University Hospital Brno and Masaryk University, Brno, Czech Republic,

² Department of Neurology, The University Hospital Brno and Masaryk University, Brno, Czech Republic,

³ Central European Institute of Technology, Masaryk University, Brno, Czech Republic

054 • PREDICTION OF CARTILAGE ENDPLATE HERNIATION IN MRI

E. Joe, J.W. Lee, G.Y. Lee, S.E. Cho, H.S. Kang

Seoul National University Bundang Hospital, Seong Nam, South Korea

055 • A CASE OF A PRESACRAL MYELOLIPOMA: IMAGING FINDINGS AND DIFFERENTIAL DIAGNOSIS CHECKLIST OF OTHER PRESACRAL MASSES

C. Gagliardo, G. Falanga, G. La Tona, A. Lo Casto, M. Midiri, R. Lagalla

Di.BI.MEF. Radiology Section, University of Palermo, Palermo, Italy

056 • LUMBAR INTRADURAL DISK EXTRUSION AND UNUSUAL MIMICS

G. Fletcher¹, J. Hoxworth¹, D. Black², T. Lidner¹

¹ Mayo Clinic Arizona, Scottsdale, AZ, USA, ² Mayo Clinic, Rochester, MN, USA

057 • MR IMAGING FINDINGS OF SPINAL ARTERIOVENOUS FISTULA

S. Cho, J. Lee, E. Kim, G. Lee

Department of Radiology, Seoul National University Bundang Hospital, Gyeonggi-Do, South Korea

058 • CYSTIC DILATATION OF VENTRICULUS TERMINALIS - A CASE REPORT

V. Boskovic, B. Georgievski Brkic, G. Milenkovic, V. Debeljkovic, B. Vukomancic, D. Veljkovic

Stroke Hospital Sveti Sava, Department of Radiology, Belgrade, Serbia

059 • NOTOCHORDAL CANAL PERSISTENCE

A. Bocchio, D. Machado, A. Rosano, D. Furfaro, T. Meloni

General Hospital U. Parini, Department of Radiology, Aosta, Italy

060 • SUBACUTE COMBINED DEGENERATION OF THORACIC AND LUMBAR SPINE - CASE REPORT

M. Baptista, M.J. Silva, A.M. Reis

Hospital Pedro Hispano, Matosinhos, Portugal

061 • THE CORRELATION BETWEEN TRANSITIONAL VERTEBRAE TYPES IN REGARDING TO THE LUMBAR DISC AND FACET DEGENERATION IN THE YOUNG MEN POPULATION WITH LOW BACK PAIN

M. Apaydin, M. Varer, E. Uluc, O. Oyar

Radiology, Izmir Katip Celebi University Ataturk Education and Training Hospital, Izmir, Turkey

062 • MRI FINDINGS IN OCCULT SPINAL DYSRAPHISM

M. Varer, M. Apaydin, F. Gelal, E. Uluç, O. Oyar

Department of Radiology, Katip Celebi University Izmir Ataturk Education and Training Hospital, Izmir, Turkey

063 • THE VALUE OF IMAGING IN THE DIAGNOSIS AND TREATMENT OF A TRAUMATIC SACRAL PSEUDOMENINGOCELE: A CASE REPORT

A. Moore¹, M. Ladino Torres², F. Rivas Rodriguez³

¹ University of Michigan, Department of Radiology, Residency Program, Ann Arbor, MI, USA, ² University

of Michigan, Department of Radiology, Division of Pediatric Radiology, Ann Arbor, MI, USA, ³ University of

Michigan, Department of Radiology, Division of Neuroradiology, Ann Arbor, MI, USA

SPINE, INTERVENTION

064 • CLINICAL EVALUATION OF A NOVEL SYSTEM FOR VERTEBRAL AUGMENTATION - CROSSTREESTM POD SYSTEM FOR OSTEOPOROTIC VERTEBRAL COMPRESSION FRACTURES IN ADULT PATIENTS

A. Rhyne¹, M. Lusk², M. Gillespy³, G. Niedzwiecki⁴, W. Olan⁵, H. Yang⁶, H. Yuan⁶, P. Yuan⁷, J. Vandevenne⁸

¹ OrthoCaroline Spine Center, Charlotte, NC, USA, ² NASA Physicians Regional Hospital Pine Ridge, Naples, FL,

USA, ³ Orthopedic Clinic of Daytona Beach, Daytona Beach, FL, USA, ⁴ Advance Imaging and Interventional

Institute, Clearwater, FL, USA, ⁵ George Washington University Hospital, Washington, DC, USA, ⁶ The First

Affiliated Hospital of Soochow University, Suzhou, China, ⁷ Long Beach Memorial Center, Memorial Orthopedic

Surgical Group, Long Beach, CA, USA, ⁸ University Hasselt, Ziekenhuis Oost-Limburg, Genk, Belgium

065 • ARTERIOVENOUS MALFORMATIONS OF THE SPINAL CORD: CHOICE OF CONTEMPORARY ENDOVASCULAR METHOD FOR TREATMENT

T. Tissen

Burdenko Neurosurgery Institute, Moscow, Russia

066 • RADIOFREQUENCY ABLATION OF SPINAL OSTEOID OSTEOMA AND OSTEOLASTOMA - TECHNICAL ADVANCES FOR PROTECTING ADJACENT NEURAL ELEMENTS AND CLINICAL SUCCESS RATES

M. Weber¹, S.D. Sprengel¹, G. Omlor², B. Lehner², H.U. Kauczor¹, C. Rehnitz¹

¹ *University Hospital Heidelberg, Department of Diagnostic and Interventional Radiology, Heidelberg, Germany,*

² *University Hospital Heidelberg, Department of Orthopaedic Surgery, Heidelberg, Germany*

STROKE AND CEREBROVASCULAR DISEASE, DIAGNOSTIC

067 • PHASE-CONTRAST SYNCHROTRON X-RAY MICROTOMOGRAPHY OF CEREBRAL PROTECTION DEVICE RETRIEVED AFTER CAROTID ARTERY STENTING

S. Youn¹, H. Kim¹, H. Lee², J. Lee², H. Kim¹

¹ *Catholic University of Daegu, Daegu, South Korea,* ² *Kyungpook National University, Daegu, South Korea*

068 • THE RELATIONSHIP BETWEEN MEAN PLATELET VOLUME AND ATTENUATION VALUES OF ACUTE INTRACEREBRAL HAEMATOMAS ON COMPUTED TOMOGRAPHY SCANS

E. Unlu¹, S. Ulu², E. Kacar¹, E. Yilmaz³, S. Ozdinc⁴, E. Dogan Baki⁵, H. Uzel Tas⁶, A. Haktanir¹

¹ *Afyon Kocatepe University Faculty of Medicine, Department of Radiology, Afyonkarahisar, Turkey,* ² *Afyon Kocatepe University Faculty of Medicine, Department of Internal Medicine, Afyonkarahisar, Turkey,* ³ *Afyon Kocatepe University Faculty of Medicine, Afyonkarahisar, Turkey,* ⁴ *Afyon Kocatepe University Faculty of*

Medicine, Department of Emergency Medicine, Afyonkarahisar, Turkey, ⁵ *Afyon Kocatepe University Faculty of Medicine, Department of Anesthesiology and Reanimation, Afyonkarahisar, Turkey,* ⁶ *Afyon Kocatepe University*

Faculty of Medicine, Department of Public Health, Afyonkarahisar, Turkey

069 • PREVALENCE OF SMALL VESSEL DISEASES IN ASIAN PATIENTS WITH SPONTANEOUS INTRACRANIAL HEMORRHAGE

S.W. Chang¹, Y.H. Tsai¹, H.H. Weng¹, M.H. Lee²

¹ *Department of Radiology, Chang Gung Memorial Hospital, Chiayi, Taiwan,* ² *Department of Neurosurgery,*

Chang Gung Memorial Hospital, Chiayi, Taiwan

070 • DIFFUSION TENSOR IMAGING IN ACUTE STROKE: CLINICAL APPLICATIONS FROM DETERMINING LESION AGE TO PREDICTING OUTCOME

J. Puig¹, G. Blasco¹, J. Daunis-I-Estadella², M. Castellanos³, J. Serena³, J. Figueras⁴, S. Pedraza¹

¹ *Department of Radiology (IDI), Girona Biomedical Research Institute (IDIBGI), Hospital Universitari Dr Josep*

Trueta, Girona, Spain, ² *Department of Computer Science, Applied Mathematics and Statistics, University of*

Girona, Girona, Spain, ³ *Department of Neurology, Girona Biomedical Research Institute (IDIBGI), Hospital*

Universitari Dr Josep Trueta, Girona, Spain, ⁴ *Department of Rehabilitation, Hospital Universitari de Girona Dr*

Josep Trueta, Girona, Spain

071 • WALL ENHANCEMENT OF THE CEREBRAL ARTERY ANEURYSMS AFTER GADOLINIUM INJECTION: EVALUATION BY MRI USING MSDE-3D-TSE SEQUENCE

S. Nagahata¹, M. Nagahata¹, M. Obara², Y. Minagawa³, S. Sato³, R. Kondo⁴, S. Saito⁴, T. Kayama⁵

¹ *Yamagata City Hospital SAISEIKAN Stroke Center, Department of Diagnostic and Interventional*

Neuroradiology, Yamagata, Japan, ² *Philips Electronics Japan, Ltd., Tokyo, Japan,* ³ *Yamagata City Hospital*

SAISEIKAN, Department of Radiology, Yamagata, Japan, ⁴ *Yamagata City Hospital SAISEIKAN Stroke Center,*

Department of Neurosurgery, Yamagata, Japan, ⁵ *Yamagata University Faculty of Medicine, Department of*

Neurosurgery, Yamagata, Japan

072 • HIV-RELATED RARE DIFFUSE ANEURYSMAL CEREBRAL VASCULOPATHY: FOUR NEW CASES AND REVIEW OF THE LITERATURE

B. Law-Ye¹, R. Richard¹, F. Clarencon², R. Blanc³, C. Jourdan⁴, D. Siahou¹, C. Wattel¹, D. Safa¹, A. Felter¹,

R. Carlier¹

¹ *Hospital Raymond Poincaré, Department of Radiology, Garches, France,* ² *Hospital Pitié-Salpêtrière,*

Department of Neuroradiology, Paris, France, ³ *Alfred de Rothschild Foundation, Department of*

Neuroradiology, Paris, France, ⁴ *Hospital Raymond Poincaré, Department of Reeducation, Garches, France*

073 • BRAIN INJURY AFTER CARDIOPULMONARY ARREST AND ITS ASSESSMENT WITH DIFFUSION-WEIGHTED MRI

Y. Ihn, W. Jung

St. Vincent's Hospital, Suwon, South Korea

074 • THE VALIDATION OF CT BRAIN PERFUSION IN PATIENTS WITH ACUTE ISCHEMIC STROKE

B. Georgievski-Brkic¹, D. Kozic², J. Ostojic³, M. Radovic-Stefanovic⁴, G. Milenkovic¹, P. Nikic⁵

¹ *Stroke Hospital Sveti Sava, Radiology Department, Belgrade, Serbia*, ² *Institution for Oncology Vojvodina, Radiology Department, Sremska Kamenica, Serbia*, ³ *Clinical Center of Vojvodina, Radiology Department, Novi Sad, Serbia*, ⁴ *Clinical Center Bežanijska Kosa, Radiology Department, Belgrade, Serbia*, ⁵ *Stroke Hospital Sveti Sava, Neurology Department, Belgrade, Serbia*

075 • NEUROIMAGING AND PATHOLOGICAL CORRELATES OF THE "IOWA" MUTATION - THE FIRST REPORTED IRISH FAMILY

L. Galvin¹, R. Grech¹, A. Chalissery², D. Mcweeney¹, L. Costello², J. Moroney², P. Brennan¹, J. Thornton¹, A. O'Hare¹, M. Farrell³, S. Looby¹

¹ *Beaumont Hospital, Department of Neuroradiology, Dublin, Ireland*, ² *Beaumont Hospital, Department of Neurology, Dublin, Ireland*, ³ *Beaumont Hospital, Department of Neuropathology, Dublin, Ireland*

076 • IMPROVED 3D PHASE CONTRAST ANGIOGRAPHIC MAGNETIC RESONANCE VENOGRAPHY OF THE BRAIN: INITIAL CLINICAL EXPERIENCE IN 25 PATIENTS

N. Campeau, A. Patton

Mayo Clinic, Rochester, MN, USA

077 • CT VENOGRAPHY IN THE EVALUATION OF CEREBRAL VENOUS SINUS THROMBOSIS

J. Avsenik¹, B. Jancheva², J. Pretnar Oblak², K. Surlan Popovic¹

¹ *Institute of Radiology, University Medical Centre, Ljubljana, Slovenia*, ² *Department of Neurology, University Medical Centre, Ljubljana, Slovenia*

078 • POSSIBILITIES OF MSCT ANGIOGRAPHY IN DETECTION AND CHARACTERIZATION OF DISTAL INTRACRANIAL ANEURYSM REPORT OF SEVEN CASES AND REVIEW OF LITERATURE

V. Vasiljevic¹, S. Milosevic Medenica²

¹ *Dptm. of Neuroradiology, Center of Radiology and MR, Clinical Center of Serbia, Belgrade, Serbia*, ² *Dptm. Of Neuroradiology, Center of Radiology and MR, Clinical Center of Serbia, Belgrade, Serbia*

079 • WORKUP OF SUSPECTED DELAYED CEREBRAL ISCHEMIA IN SUBARACHNOID HEMORRHAGE: A DECISION ANALYSIS

S. Rawal¹, C. Barnett Tapia², A.A. John-Baptiste³, H.H. Thein⁴, T. Krings¹

¹ *Toronto Western Hospital, University of Toronto, Division of Neuroradiology, Department of Medical Imaging, Toronto, Canada*, ² *Toronto General Hospital, University of Toronto, Department of Neurology, Toronto, Canada*, ³ *Women's College Research Institute, Women's College Hospital, University of Toronto, Toronto, Canada*, ⁴ *Dalla Lana School of Public Health, University of Toronto, Toronto, Canada*

080 • HEMODYNAMIC ALTERATIONS IN CEREBRAL BLOOD VESSELS AFTER CAROTID ARTERY REVASCULARISATION: QUANTITATIVE ANALYSIS USING 2D PHASE-CONTRAST MRI

S. Youn¹, H. Kim¹, Y. Doh¹, J. Doh¹, J. Lee²

¹ *Catholic University of Daegu, Daegu, South Korea*, ² *Kyungpook National University, Daegu, South Korea*

STROKE AND CEREBROVASCULAR DISEASE, INTERVENTIONAL: ANEURYSMS AND VASCULAR MALFORMATIONS

081 • ENDOVASCULAR TREATMENT OF INTRACRANIAL ANEURYSMS ARISING FROM FENESTRATION: REPORT OF THREE CASES AND THE REVIEW OF LITERATURE

S. Milosevic Medenica

Department of Neuroradiology, Center of Radiology and MR, Clinical Center of Serbia, Belgrade, Serbia

082 • WHAT ABOUT ANEURYSM SAC THROMBOSIS AT DAY 1 AFTER FLOW-DIVERTER STENTING OF INTRACRANIAL ANEURYSMS? A RETROSPECTIVE CASE SERIES

J. Gabrieli, F. Clarençon, F. Di Maria, L. Le Jean, J. Chiras, N. Sourour

Department of Interventional Neuroradiology, Pitié-Salpêtrière Hospital, Paris VI University, Paris, France

083 • INTEREST OF FLAT PANEL VOLUME CT ANGIOGRAPHY TO EVALUATE THE ACCURATE DEPLOYMENT OF FLOW-DIVERTER STENTS

J. Gabrieli, F. Clarençon, F. Di Maria, L. Le Jean, J. Chiras, N. Sourour

Department of Interventional Neuroradiology, Pitié-Salpêtrière Hospital, Paris VI University, Paris, France

084 • INTRACRANIAL VESSELS VISUALIZATION FOR KEY-HOLE SURGERY OF ARTERIAL ANEURYSMS UNDER THE NAVIGATIONAL CONTROL

A. Arablinsky, A. Gorozhanin, I. Danchenko, D. Vakатов, A. Osipovskay

Moscow State Medical Institution Municipal Clinical Hospital N.A. S.P. BOTKIN, Moscow, Russia

085 • ENDOVASCULAR TREATMENT OF ACUTELY RUPTURED WIDE-NECKED INTRACRANIAL ANEURYSMS: SAFETY AND EFFICACY OF DOUBLE MICROCATETER TECHNIQUE

P. Yoon¹, J. Lee¹, Y. Lee², K. Yang²

¹ NHIS Ilsan Hospital, Department of Radiology, Goyang, South Korea, ² NHIS Ilsan Hospital, Department of Neurosurgery, Goyang, South Korea

086 • ROLE OF COMPUTED TOMOGRAPHY ANGIOGRAPHY/PERFUSION (CTA-CTP) IN THE BLOOD PRESSURE (BP) MANAGEMENT IN ACUTE SUBARACHNOID HEMORRAGE (SH) DUE TO ANEURYSM RUPTURE

E. Puglielli¹, M. Bafile², M. Fuschi¹, M. Varrassi¹, V. Di Egidio³

¹ Interventional and Vascular Radiology, G. Mazzini Hospital, Teramo, Italy, ² Department of Anesthesia and Intensive Care, S. Salvatore Hospital, L'Aquila, Italy, ³ General and Interventional Radiology, S. Spirito Hospital, Pescara, Italy

087 • CLINICAL AGGRESSIVE CAVERNOUS SINUS DURAL ARTERIOVENOUS FISTULA: ANGIO-ARCHITECTURE ANALYSIS AND EMBOLISATION BY VARIOUS APPROACHES

C. Luo¹, Y. Tsai³, F. Chang^{1,2}, M. Teng^{1,2}, C. Lin^{1,2}, W. Guo^{1,2}

¹ Department of Radiology, Taipei Veterans General Hospital, Taipei, Taiwan, ² Department of Radiology, National Yang-Ming University School of Medicine, Taipei, Taiwan, ³ Department of Diagnostic Radiology, Chang-Gung Memorial Hospital, Chiayi, Taiwan

088 • DOUBLE MICROCATETER TECHNIQUE FOR COIL EMBOLIZATION OF OVERWIDE AND UNDERTALL SMALL ANEURYSMS

D. Kim, B.M. Kim, N.Y. Shin, E.H. Ihm, J.H. Baek, D.I. Kim

Yonsei University College of Medicine, Department of Radiology, Seoul, South Korea

STROKE AND CEREBROVASCULAR DISEASE, INTERVENTIONAL: VESSEL OBSTRUCTIONS AND RECANALISATION

089 • SAFETY AND OUTCOME OF ACUTE STROKE TREATMENT WITH THE SOLITAIRE FR STENT RETRIEVER IN 227 PATIENTS

P.P. Gratz¹, S. Jung², G. Schroth¹, J. Gralla¹, P. Mordasini¹, K. Hsieh¹, M.R. Heldner², H.P. Mattle², M. Mono², U. Fischer², M. Arnold², C. Zubler¹

¹ Department of Diagnostic and Interventional Neuroradiology, Inselspital, University Hospital Bern and University of Bern, Bern, Switzerland, ² Department of Neurology, Inselspital, University Hospital Bern and University of Bern, Bern, Switzerland

090 • CHANGES OF CEREBRAL PERFUSION IN PATIENTS WITH MODERATE AND SEVERE CAROTID ARTERY STENOSIS AFTER STENTING

A. Sergeeva, M.V. Krotenkova, R.N. Kononov, A.S. Suslin, M.A. Piradov

Research center of neurology RAMS, Moscow, Russia

091 • RADIOLOGIC EVALUATION OF TOP OF THE BASILAR SYNDROME

Y. Kiroglu¹, C. Oncel², A. Kocyigit³

¹ Pamukkale Univ. Medical Faculty, Department of Radiology, Denizli, Turkey, ² Pamukkale Univ. Medical Faculty, Department of Neurology, Denizli, Turkey, ³ Pamukkale Univ. Medical Faculty, Department of Radiology, Denizli, Turkey

092 • ISCHEMIC BRAIN CHANGES ASSOCIATED WITH CEREBRAL ANGIOGRAPHY EVALUATION OF DIFFUSION WEIGHTED MAGNETIC RESONANCE IMAGING

T. İkizceli¹, H. Donmez², E. Serifov³, A. Candan Durak², G. Kahrman², S. Senol²

¹ Haseki Education and Research Hospital, Istanbul, Turkey, ² University of Erziyes, School of Medicine, Kayseri, Turkey, ³ The Centre of Nahcivan Hospital, Baku, Azerbaijan

093 • DETECTION OF EMBOLIC COMPLICATIONS FOLLOWING STENT RETRIEVER DEPLOYMENT IN ANTERIOR CIRCULATION STROKES: AN SWI STUDY

P.P. Gratz¹, G. Schroth¹, C. Weisstanner¹, U. Fischer², S. Jung², M.R. Heldner², C. Kiefer¹, J. Gralla¹, P. Mordasini¹, F. Kellner-Weldon¹, C. Zubler¹, K. Hsieh¹, M. El-Koussy¹

¹ Department of Diagnostic and Interventional Neuroradiology, Inselspital, University Hospital Bern and University of Bern, Bern, Switzerland, ² Department of Neurology, Inselspital, University Hospital Bern and University of Bern, Bern, Switzerland

OTHER/FREE TOPICS

094 • PEDIATRIC SJÖGREN-LARSSON SYNDROME AND ADULT PRIMER SJÖGREN'S SYNDROME: BRAIN INVOLVEMENT

H. Kalkan, O. Babaoglu, D. Kiresi

Necmettin Erbakan University, Meram School of Medicine, Department of Radiology, Konya, Turkey

095 • NORMAL BASAL GANGLIA SIGNAL FROM 3T AND 1.5T MRI SCANNERS IN DIFFERENT AGE GROUPS

N. Leela, A. Rana

Aberdeen Royal Infirmary, Aberdeen, United Kingdom

096 • HYPOPHYSIS MRI FINDINGS DUE TO IRON OVERLOAD IN TWO TRANSFUSION- DEPENDENT BETA THALASSAEMIA MAJOR PATIENTS

H. Kalkan, D. Kiresi

Necmettin Erbakan University, Meram School of Medicine, Department of Radiology, Konya, Turkey

097 • ASSESSMENT OF NEURAL IMPAIRMENT IN OBSTRUCTIVE SLEEP APNOEA SYNDROME: CAN APPARENT DIFFUSION COEFFICIENT MEASUREMENTS BE USEFUL?

E. Kacar¹, S.S. Ulasli², G. Gungor¹, E. Unlu¹, T. Koyuncu², A. Haktanir¹, M. Unlu²

¹ Kocatepe University, Department of Radiology, Afyonkarahisar, Turkey, ² Kocatepe University, Department of Respiratory Diseases, Afyonkarahisar, Turkey

098 • ACUTE INFARCTIONS IN PATIENTS WITH COGNITIVE FUNCTION IMPAIRMENTS

Y. Hwang, S. Lee, B. Lee, S. Kim

Inje University Ilsan Paik Hospital, Goyang, South Korea

099 • RADIOGRAPHIC SCREENING OF SCOLIOSIS: PREVALENCE STUDY IN YOUNG KOREAN MILITARY RECRUITS

T. Ha, K. Chang, J. Hur

Incheon Regional Military Manpower Administration, Incheon, South Korea

100 • EMERGING ROLE OF ULTRASOUND IMAGING ASSOCIATED TO CLINICAL NEUROPHYSIOLOGY AS A SUPPLEMENTARY DIAGNOSTICS TECHNIQUE OF PERIPHERAL NERVES PATHOLOGIES: A SICILIAN EXPERIENCE

A. Gagliardo^{1,2}, C. Avarino¹, G. Giaimi¹, D. Di Matteo¹, M. Midiri², C. Gagliardo²

¹ Clinical Course, Neurophysiology Unit, NHS accredited, Palermo, Italy, ² Di.BI.MEF., Radiology Section, University of Palermo, Palermo, Italy

101 • DO EXPERT SECONDARY READS OF OUTSIDE NEUROIMAGING EXAMINATIONS ADD CLINICAL VALUE?

G. Fletcher¹, J. Melikian², M. Patel¹

¹ Mayo Clinic Arizona, Dept of Diagnostic Radiology, Scottsdale, AZ, USA, ² Arizona State University, Tempe, AZ, USA

102 • ALTERED AXONAL INTEGRITY OF LOWER LIMB MOTOR TRACTS IN IDIOPATHIC NORMAL PRESSURE HYDROCEPHALUS: A DTI BIOMARKER FOR DIFFERENTIATING LUMBAR-DRAINAGE RESPONDERS FROM NON-RESPONDERS

C. Chen¹, S. Chiang², S. Chung³, H. Kao²

¹ Taipei Medical University Hospital, Department of Medical Imaging, Taipei, Taiwan, ² Tri-Service General Hospital, Department of Radiology, Taipei, Taiwan, ³ National Taiwan University, Department of Electrical Engineering, Taipei, Taiwan

103 • CAROTID INTIMA-MEDIA THICKNESS INCREASE IN SLEEP DISORDERS

M. Apaydin¹, S.O. Ayik², M. Varer¹, G. Akhan³, S. Peker³, E. Uluc¹

¹ Department of Radiology, Katip Celebi University Ataturk Education and Training Hospital, Izmir, Turkey,

² Department of Chest Disorders, Katip Celebi University Ataturk Education and Training Hospital, Izmir, Turkey,

³ Department of Neurology, Katip Celebi University Ataturk Education and Training Hospital, Izmir, Turkey

104 • RADIOLOGICAL FEATURES OF ENCEPHALOPATHY ASSOCIATED WITH E. COLI O111 OUTBREAK IN JAPAN

J. Takanashi¹, H. Tada², H. Taneichi³, A. Okumura⁴, H. Terada¹, M. Mizuguchi⁵

¹ Toho University, Sakura Medical Center, Sakura, Japan, ² Saiseikai Narashino Hospital, Narashino, Japan,

³ University of Toyama, Toyama, Japan, ⁴ Juntendo University Faculty of Medicine, Tokyo, Japan, ⁵ Graduate School of Medicine, University of Tokyo, Tokyo, Japan

105 • AMNESTIC SYNDROMES AND LESIONS WITH HIGH DIFFUSION SIGNAL IN THE LIMBIC SYSTEM AND HIPPOCAMPUS - A PICTORIAL ESSAY

M. Sarpi, M. Docema, M. Martin, L. Silva, L. Godoy, D. Delgado, H. Lee

Hospital Sirio Libanês, São Paulo, Brazil

106 • THE UTILITY OF WHITE MATTER VOLUME LOSS ANALYSIS USING SPM8 PLUS DARTEL IN THE DIFFERENTIATION BETWEEN CORTICOBASAL DEGENERATION AND PROGRESSIVE SUPRANUCLEAR PALSY

K. Sakurai¹, E. Imabayashi¹, A. Tokumaru¹, S. Hasebe¹, S. Murayama², M. Takao², K. Kanemaru³,

S. Morimoto³, H. Matsuda⁴, Y. Shibamoto⁵

¹ Department of Diagnostic Radiology, Tokyo Metropolitan Medical Center of Gerontology, Tokyo, Japan,

² Department of Neuropathology (the Brain Bank for Aging Research), Tokyo Metropolitan Medical Center of Gerontology, Tokyo, Japan, ³ Department of Neurology, Tokyo Metropolitan Geriatric Hospital, Tokyo, Japan,

⁴ Integrative Brain Imaging Center, National Center of Neurology and Psychiatry, Kodaira, Japan, ⁵ Department of Radiology, Nagoya City University Graduate School of Medical Sciences, Nagoya, Japan

¹ Hospital Del Rosario, Madrid, Spain, ² Hospital Son Espases, Palma De Mallorca, Spain

107 • BASILAR ARTERY HYPOPLASIA AND PERSISTENCE OF CAROTID-VB COMMUNICATIONS

D. Quiñones¹, A. Mas Bonet², C. Andreu¹, M. Picado², A. Moll², P. Jimenez-Arribas², S. Miralbés²

¹ Hospital Del Rosario, Madrid, Spain, ² Hospital Son Espases, Palma De Mallorca, Spain

108 • NEUROCYSTICERCOSIS FOR DUMMIES

J. Nair¹, J. Chankowsky¹, C.I. Torres¹, S. Jaggi², I. Talwar², P. Parizel³, R. Del Carpio-O'Donovan¹,

J. Beegom Mansoor⁴

¹ Dept of Radiology, Montreal General Hospital, McGill University, Montreal, Canada, ² Dept of Radiology,

Bombay Hospital Institute of Medical Sciences, Mumbai, India, ³ Dept of Radiology, University of Antwerp,

Antwerp, Belgium, ⁴ Baraha Hospital, Ministry of Health, Dubai, United Arab Emirates

109 • ANALYSIS OF CSF FLOW DYNAMICS USING CSF FLOW VOID PHENOMENON AND PHASE CONTRAST CINE MRI IN NORMAL PRESSURE HYDROCEPHALUS COMPARED TO SUBCORTICAL VASCULAR DEMENTIA AND HEALTHY VOLUNTEER

C. Wirojitananugoon, B. Hooncharoen, J. Laothamatas, S. Chansirikarnjana

Ramathibodi Hospital, Mahidol University, Bangkok, Thailand

110 • MAGNETIC RESONANCE IMAGING IN DIAGNOSIS OF VASCULITIS OF INTERNAL CAROTID, VERTEBRAL, AND BASILAR ARTERIES

E. Seliverstova, L. Dobrynina, M. Krotenkova, L. Kalashnikova

Research Center of Neurology, Russian Academy of Medical Sciences, Moscow, Russia

111 • GOSSYPBOMA - AN UNUSUAL INTRACRANIAL MIMIC IN A CHILD

E. Ryan, N. Adams, P. Brennan, A. O'Hare, M. Thornton, S. Looby

Department of Neuroradiology, Beaumont Hospital, Dublin, Ireland

112 • NON-TRAUMATIC INTRA CEREBRAL HEMORRHAGE- A PICTORIAL ASSAY

J. Nair¹, S. Jaggi², S. Shah², J. Chankowsky¹, C.I. Torres¹, I. Talwar², R. Del-Carpio-O'Donovan¹,

J. Beegom Mansoor³

¹ Department of Radiology, Montreal General Hospital, McGill University, Montreal, Canada, ² Department of

Radiology, Bombay Hospital, Mumbai, India, ³ Baraha Hospital, Ministry of Health, Dubai, United Arab Emirates

113 • APPROACHING THE TRIGEMINAL NERVE. OUR EXPERIENCE IN CT-GUIDED PROCEDURES

J. Ortiz¹, J. Ocampo¹, J. Abreu¹, J. Moyano¹, J. Tejada², N. Useche¹, S. Bermudez¹

¹ Hospital Universitario Fundacion Santafe de Bogota, Bogota, Colombia, ² IU Health University Hospital, Indianapolis, IN, USA

ADVANCED/NEW IMAGING MODALITIES

114 • DISRUPTION OF DEFAULT NETWORK ACTIVITY IN ACUTE STROKE PATIENTS WITH EARLY IMPAIRMENT IN CONSCIOUSNESS

Y. Tsai¹, H.H. Weng², B. Biswal³, C.P. Lin¹, R. Yuan³

¹ National Yang Ming University, Department of Biomedical Imaging and Radiological Sciences, Taipei, Taiwan,

² Chang Gung Memorial Hospital at Chiay, Department of Diagnostic Radiology, Chiayi, Taiwan, ³ New Jersey Institute of Technology, Department of Biomedical Engineering, Newark, NJ, USA

115 • VALUE OF FOUR-DIMENSIONAL MR ANGIOGRAPHY AT 3.0T COMPARED TO DSA FOR THE FOLLOW-UP OF TREATED BRAIN ARTERIOVENOUS MALFORMATIONS

S. Soize¹, K. Kadziolka¹, F. Bouquigny¹, C. Portefaix², L. Pierot¹

¹ Hospital Maison Blanche, Department of Radiology, Reims, France, ² CReSTIC SIC EA3804, University of Reims, Reims, France

116 • DIFFUSION TENSOR TRACTOGRAPHY IN MESIAL TEMPORAL SCLEROSIS SURGERY: AN INSTITUTIONAL EXPERIENCE

D. Siu¹, X.L. Zhu², Y.X. Wang¹, J.M. Abrigo¹, J.C.S. Leung³, C.H.K. Mak², W.S. Poon²

¹ Chinese University of Hong Kong, Department of Imaging and Interventional Radiology, Hong Kong, Hong Kong,

² Chinese University of Hong Kong, Division of Neurosurgery, Department of Surgery, Hong Kong, Hong Kong, ³ Chinese University of Hong Kong, Department of Ophthalmology, Hong Kong, Hong Kong

117 • EVALUATION OF CEREBRAL BLOOD FLOW USING PASL IN HEALTHY VOLUNTEERS

E. Shults¹, I. Proinin¹, L. Fadeeva¹, A. Celik², V. Kornienko¹

¹ Burdenko Neurosurgery Institute, Neuroradiology, Moscow, Russia, ² Clinical Science Development Group, GE Healthcare, Istanbul, Turkey

118 • THE USE OF fMRI IN CLINICAL PRACTICE BEYOND PRESURGICAL PLANNING: IMAGINARY, LANGUAGE AND OLFACTORY PARADIGMS

H. Felgueiras¹, P. Branco², T. Santos¹, H. Morais¹, M. Veloso¹, J. Spratley^{2,3}, P. Abreu^{2,3}, D. Seixas^{2,3}

¹ Centro Hospitalar de Vila Nova de Gaia/Espinho, Vila Nova De Gaia, Portugal, ² Faculty of Medicine of Porto University, Porto, Portugal, ³ Centro Hospitalar São João, Porto, Portugal

119 • ARTERIAL SPIN LABELING, DIFFUSION-TENSOR IMAGING AND FDG-PET IN FOCAL CORTICAL DYSPLASIA

S. Sarria Estrada¹, M. Toledo², G. Cuberas-Borrós³, C. Lorenzo-Bosquets³, C. Vert¹, C. Auger¹, A. Rovira¹

¹ Magnetic Resonance Unit, Radiology Department. Vall d'Hebrón University Hospital, Barcelona, Spain, ² Epilepsy Unit, Neurology Department. Vall d'Hebrón University Hospital, Barcelona, Spain, ³ Nuclear Medicine Department. Vall d'Hebrón University Hospital, Barcelona, Spain

120 • ARTERIAL SPIN LABELING AND ITS APPLICATIONS IN PEDIATRIC CENTRAL NERVOUS SYSTEM. PICTORIAL REVIEW

A. Sanchez-Montanez, J.P. Salazar, I. Delgado, J.F. Corral, M. Fernandez, E. Vazquez

Vall D'Hebron University Hospital, Diagnostic Imaging, Barcelona, Spain

121 • DIFFUSION TENSOR MR IMAGING AND TRACTOGRAPHY AT 3.0T: ANATOMY AND CLINICAL APPLICATIONS

M. Recio¹, L.C. Hernández², J. Carrascoso¹, R. Cano¹, A. Alvarez¹, V. Martínez De Vega¹

¹ Hospital Universitario Quirón Madrid, Pozuelo De Alarcón, Spain, ² Departamento De Morfología Y Biología Celular, Facultad De Medicina. Universidad de Oviedo, Oviedo, Spain

122 • THE ARCUATE FASCICULUS : ANALYSIS OF WHITE MATTER CONNECTION IN THAI LANGUAGE SYSTEM USING DIFFUSION TENSOR IMAGING

C. Ngamsombat¹, J. Wongsripumtet¹, S. Manochiopinig², S. Piyaapittayanan¹, S. Chaovongphanit³, O. Chawalparit¹

¹ Department of Radiology, Siriraj Hospital, Bangkok, Thailand, ² Department of Physical Therapy, Siriraj Hospital, Bangkok, Thailand, ³ Department of Radiation Technique, Faculty of Technical Medicine, Siriraj Hospital, Bangkok, Thailand

123 • PERCENT PERFUSION-TERRITORY AREA (%PT-A) CALCULATED BY TERRITORIAL ASL IMAGING: A UNIQUE PARAMETER TO INDICATE INTRACRANIAL HEMODYNAMICS

M. Nagahata¹, M. Obara², Y. Minagawa³, S. Sato³, S. Nagahata¹, R. Kondo⁴, S. Saito⁴, T. Kayama⁵

¹ Yamagata City Hospital SAISEIKAN Stroke Center, Department of Diagnostic and Interventional Neuroradiology, Yamagata, Japan, ² Philips Electronics Japan, Ltd., Tokyo, Japan, ³ Yamagata City Hospital SAISEIKAN, Department of Radiology, Yamagata, Japan, ⁴ Yamagata City Hospital SAISEIKAN Stroke Center, Department of Neurosurgery, Yamagata, Japan, ⁵ Yamagata University Faculty of Medicine, Department of Neurosurgery, Yamagata, Japan

124 • CORRELATION BETWEEN ARTERIAL SPIN LABELING AND DYNAMIC SUSCEPTIBILITY CONTRAST PERFUSION MRI IN THE EVALUATION OF THE INTRACRANIAL LESIONS AT 3-TESLA MR

O. Kitis¹, A. Tosun², C. Eraslan¹, E. Ozgiray³, T. Yurtseven³, Y. Ertan⁴, M.C. Calli¹

¹ Ege University, School of Medicine, Radiology Dept, Izmir, Turkey, ² Izmir Bozyaka Education and Research Hospital, Radiology Dept, Izmir, Turkey, ³ Ege University, School of Medicine, Neurosurgery Dept, Izmir, Turkey, ⁴ Ege University, School of Medicine, Pathology Dept, Izmir, Turkey

125 • HIPPOCAMPAL REVERSIBLE LESIONS IN A CASE OF TRANSIENT GLOBAL AMNESIA

C. Gagliardo, F. Barone, F. Bencivinni, A. Banco, M. Midiri

DI.BI.MEF, Radiology Section, University of Palermo, Palermo, Italy

126 • QUANTITATIVE T2*-MAPPING IN PARKINSON'S DISEASE USING AN AUTOMATED INVESTIGATOR INDEPENDENT "REGION-OF-INTEREST"-BASED APPROACH

K. Egger¹, M. Obmann¹, R. Schwarzwald¹, H. Mast¹, L. Köstering², C. Kaller², S. Klöppel², F. Amtage³, I. Mader¹

¹ Dept. of Neuroradiology, University Medical Center, Freiburg, Germany, ² Freiburg Brain Imaging Center, Freiburg, Germany, ³ Dept. of Neurology, University Medical Center, Freiburg, Germany

127 • QUANTIFYING THE CHANGES OF WHITE MATTER OF NORMAL ELDERLY IN DIFFUSION TENSOR IMAGING

C. Chen¹, J.C. Fu², S.H. Tsai¹, J.W. Chai¹, C. Troy³, S.K. Lee¹

¹ Department of Radiology, Taichung Veterans General Hospital, Taichung, Taiwan, ² National Yunlin University of Science and Technology, Yunlin, Taiwan, ³ Dayeh University, Changhua, Taiwan

128 • UNDERSTANDING SOCIAL COGNITION ABILITIES IN TRAUMATIC BRAIN INJURY SUBJECTS: A PILOT STUDY OF FUNCTIONAL MRI fMRI IN TRAUMA BRAIN INJURY (TBI) COLOMBIAN PATIENTS

S. Bermudez¹, D. Matallana^{1,2}, P. Reyes², J. Castro³, A.J. Morillo¹, C. Filizzola², G. Santiago¹, B. Bernal⁴

¹ Fundacion Santa Fe de Bogotá University Hospital, Bogotá, Colombia, ² Xaveriana University Psychiatric Department, Bogotá, Colombia, ³ Los Andes University Biomedical Engineering, Bogotá, Colombia, ⁴ fMRI Consulting Miami Children Hospital, Miami, FL, USA

129 • FUNCTIONAL MAGNETIC RESONANCE IN MEDICINE STUDENTS WITH AND WITHOUT PARTIAL SLEEP RESTRICTION

S. Bermudez¹, J.T. Hernandez², I. Perez³, A.J. Morillo¹, B. Bernal⁴, G. Santiago¹, S. Torres², A. Ocampo¹,

M. Ibañez², S. Rascovsky⁵, A. Sanz⁵, P. Reyes¹

¹ Fundación Santa Fe de Bogotá University Hospital, Bogotá, Colombia, ² Los Andes University Imagine group, Bogotá, Colombia, ³ El Rosario University NeURos group, Bogotá, Colombia, ⁴ fMRI Consulting Miami Children Hospital, Miami, FL, USA ⁵ IATM Instituto de Alta Tecnología Médica de Antioquia, Medellín, Colombia

130 • H-MR-SPECTROSCOPY OF INFERIOR COLLICULUS AS A TOOL FOR EARLY DIAGNOSIS OF ALZHEIMER DISEASE IN A FEASIBILITY STUDY

Y. Aghazadeh¹, B. Kress¹, V. Paulose², A. Sagheer³, F. Shad Kaneez³, A. Quirbach⁵, N. Hj Azaman⁴

¹ Hospital Nordwest Frankfurt, Frankfurt, Germany, ² Jerudong Park Medical Center Brunei, ³ Institute of Health Sciences-University Brunei Darussalam Brunei, ⁴ RIPAS Hospital Brunei, ⁵ Dr. Horst-Schmidt-Kliniken, Wiesbaden, Germany

INDUSTRY SPONSORED LUNCH SYMPOSIA

Sunday, September 29

Room HZ 4

12:45 - 13:45

Symposium with the unrestricted educational grant of BRACCO
Neuroimaging in emergency and non-emergency settings

Chair: F.E. Zanella (Germany)

The role of MRI in diagnosing and monitoring multiple sclerosis

A. Rovira (Spain)

The role of CT in brain perfusion imaging

C. Ozoba (Switzerland)

Room HZ 3

13:00 - 13:30

Symposium with the unrestricted educational grant of PENUMBRA
Ischemic Stroke Intervention after IMS3

Thrombectomy with direct aspiration, return of experience

R. Von Kummer (Germany)

Acute Stroke Intervention with the ADAPT

J. Milburn (USA)

Room HZ 4

15:25 - 15:35

Lecture with the unrestricted educational grant of PHILIPS

New ways of high resolution imaging in interventional practice

L. Spelle (France)

Monday, September 30

Room HZ 3

13:00 - 14:00

Symposium with the unrestricted educational grant of MICROVENTION

First experiences with the thrombectomy device ERIC

T. Liebig (Germany)

Next Generation Flowdiverter FRED

J. Fiehler (Germany)

Room HZ 4

13:00 - 13:30

Symposium with the unrestricted educational grant of SIEMENS

Flat panel c-arm systems: Artist Q - the next generation

M. Skalej (Germany)

Acknowledgements

**ESNR and the President of the 37th ESNR Annual Meeting -
21st Advanced Course in Diagnostic Neuroradiology
5th Advanced Course in Interventional Neuroradiology**

**wish to express their gratitude
to all those who have given their unrestricted support to the event:**

Platinum Sponsors

Bracco

MicroVention

Gold Sponsors

Codman - Depuy Synthes

Guerbet

Penumbra

Silver Sponsors

Covidien

Stryker

Further Sponsors and Exhibitors

AB Medica

Acandis

Amirsys

Bayer Healthcare

Bender - Be Imaging

Mallinckrodt

Medtron

NordicNeuroLab

Olea Medical

Phenox

Philips

Sequent Medical

Siemens

TeraRecon

Wisepress

37th ESNR ANNUAL MEETING

EXHIBITION - GROUND FLOOR

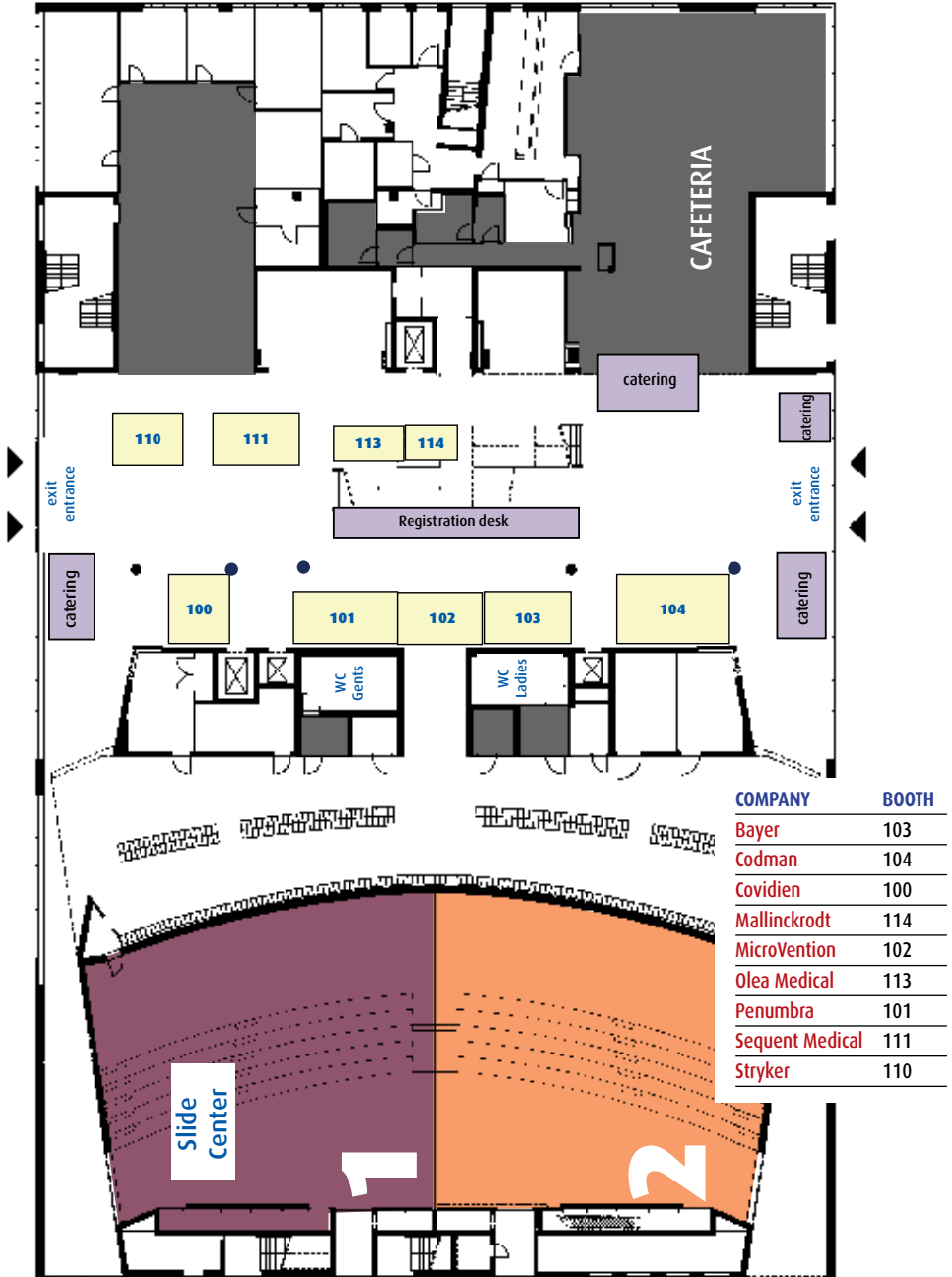

37th ESNR ANNUAL MEETING

EXHIBITION - FIRST FLOOR

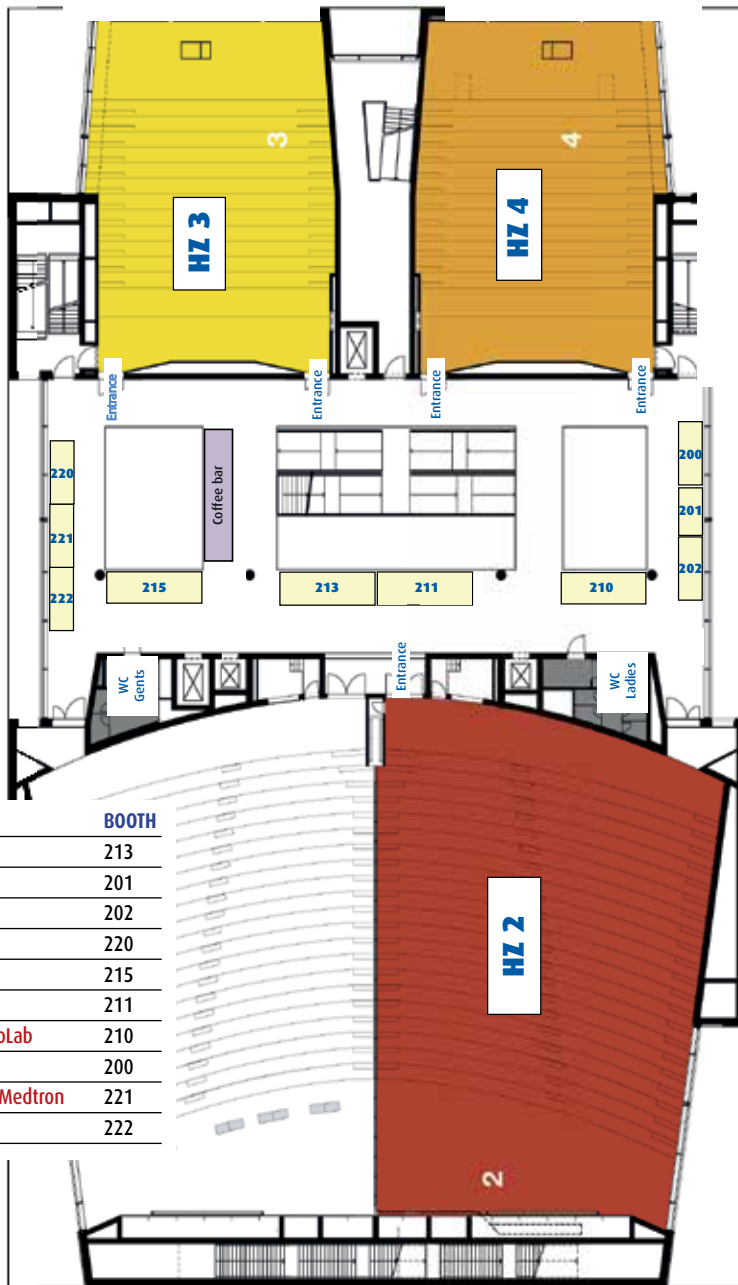

COMPANY	BOOTH
AB Medica	213
AcanDis	201
Amirsys	202
Be-Imaging	220
Bracco	215
Guerbet	211
NordicNeuroLab	210
Phenox	200
TeraRecon/Medtron	221
Wisepress	222

37th ESNR ANNUAL MEETING

SECOND FLOOR



THIRD FLOOR

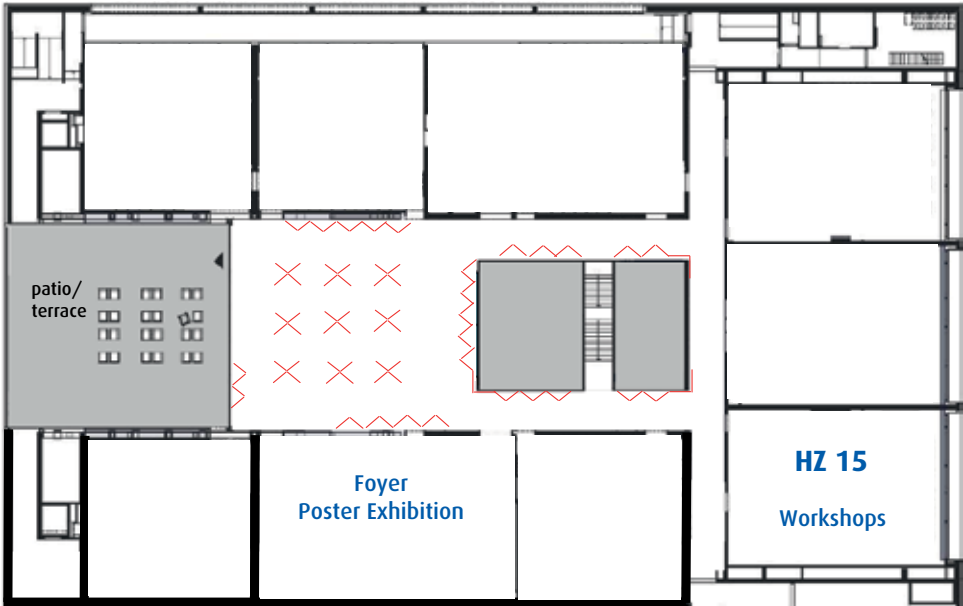

Contacts

ESNR Central Office



European Society of Neuroradiology
Zürich - Switzerland
info@esnr.org
www.esnr.org

Congress Organisation, Housing, Exhibition and Sponsoring



AIM GROUP INTERNATIONAL

Milan Office
Via G. Ripamonti, 129 - 20141 Milano, Italy
Ph.: +39 02 56601.1
Fax: +39 02 56609045
esnr2013@aimgroup.eu



Kongress- und MesseBüro Lentzsch GmbH

Gartenstraße 29
61352 Bad Homburg
info@kmb-lentzsch.de
Phone: +49 6172 6796-14
Fax: +49 6172 6796-26
www.kmb-lentzsch.de

NOTES

A series of horizontal dotted lines for taking notes.

NOTES

A series of horizontal dotted lines for taking notes.

IMPROVED

Delivery
& Tracking
across all sizes*

Now in a
2mm size!

Surpass[™]
FLOW DIVERTER

Consistency Matters

www.stryker.com/emea/neurovascular

**Bench test results may not necessarily be indicative of clinical performance.
Testing completed by Stryker Neurovascular. Data on file and available upon request.*

INTENDED USE/INDICATIONS FOR USE

The Surpass Flow Divarter is indicated for the treatment of saccular or fusiform intracranial aneurysms arising from a parent vessel with a diameter of $\geq 2\text{mm}$ and $\leq 5.3\text{mm}$.

This document is intended solely for the use of healthcare professionals.

A physician must always rely on his or her own professional clinical judgment when deciding whether to use a particular product when treating a particular patient. Stryker does not dispense medical advice and recommends that physicians be trained in the use of any particular product before using it in a procedure. The information presented is intended to demonstrate the breadth of Stryker product offerings. A physician must always refer to the package insert, product label and/or instructions for use before using any Stryker product. Products may not be available in all markets because product availability is subject to the regulatory and/or medical practices in individual markets. Please contact your Stryker representative if you have questions about the availability of Stryker products in your area.

CODMAN NEURO

DePuySynthes
COMPANIES OF *Johnson & Johnson*

ENGAGE WITH THE NEW

REVIVE™ SE
thrombectomy device

Engage • Extract • Enable
Now, with enhanced navigability



Clear the Way

Visit our booth for more information